



31-33 Durham Court PARK RIDGE SOUTH, QLD 4 2 7

ACREAGE, SHEDS AND POOL!

Nestled on 4,400m2 this amazing property will appeal to those who are seeking a lifestyle in tune with nature without sacrificing the ability of commuting to the city and suburbs.

Hidden amongst lovely gardens is a long concrete driveway which leads you to a fantastic home which exudes a warm, welcoming ambience. This home has a master bedroom with sliding doors leading out to a covered verandah and welcoming garden, plus 3 other bedrooms, spacious open plan living area with charming slow combustion fireplace and modern kitchen. Enjoy the soothing environment with wrap around verandahs on 3 sides and a massive covered entertaining area overlooking the enormous in-ground salt water pool.

Featuring a 15m x 7m powered shed plus a 2nd 9m x 7m shed suitable for multiple vehicles and a perfect opportunity to run a business from home. There are so many options for this wonderful property!

Price: Offers Over \$590,000

**Stone Real Estate -
Head Office**



Internal Area 131 m² | External Area 198 m² | Total Area 329 m²

WHILE EVERY EFFORT IS MADE TO ENSURE THAT THIS PLAN AND INFORMATION CONTAINED WITHIN IS AS ACCURATE AS POSSIBLE, IT IS FOR ILLUSTRATIVE PURPOSES ONLY AND NOT GUARANTEED TO BE EXACT. INTERESTED PARTIES SHOULD MAKE THEIR OWN ENQUIRIES.



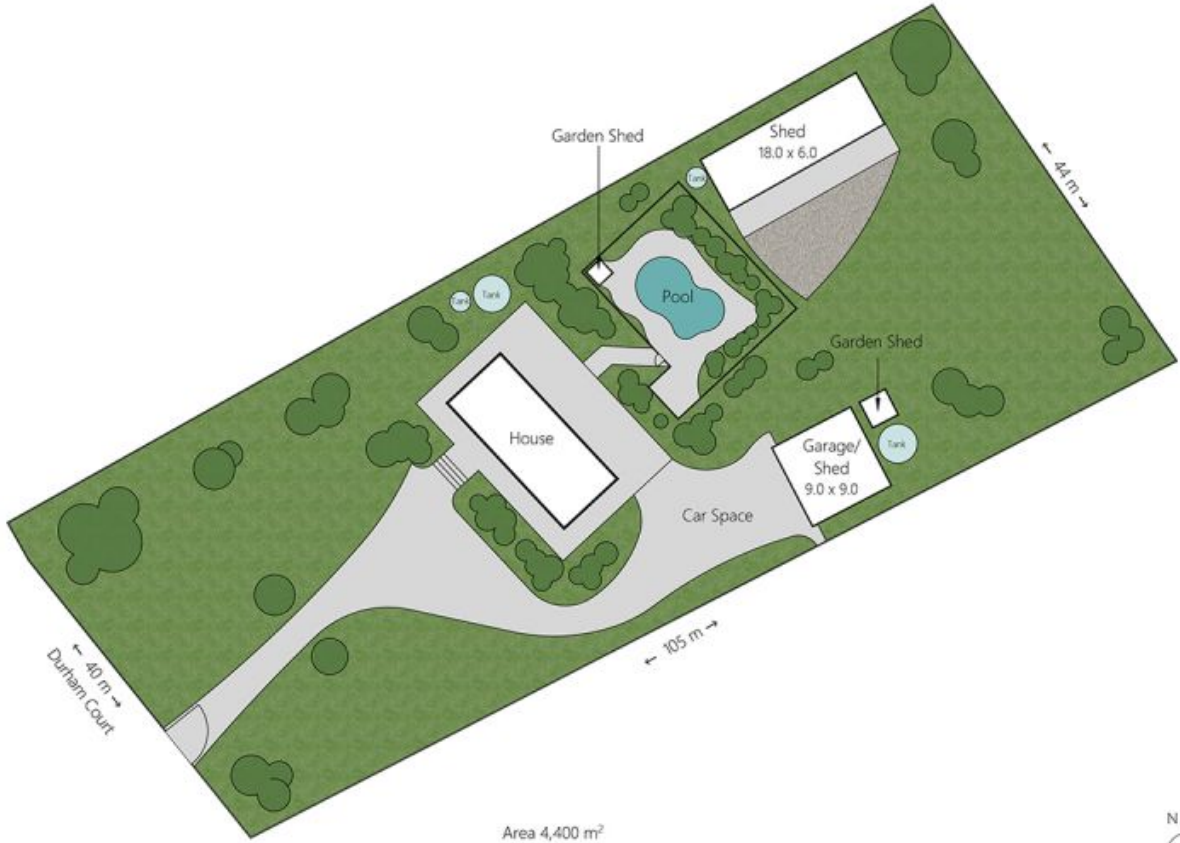

Area 4,400 m²

WHILE EVERY EFFORT IS MADE TO ENSURE THAT THIS PLAN AND INFORMATION CONTAINED WITHIN IS AS ACCURATE AS POSSIBLE, IT IS FOR ILLUSTRATIVE PURPOSES ONLY AND NOT GUARANTEED TO BE EXACT. INTERESTED PARTIES SHOULD MAKE THEIR OWN ENQUIRIES.

