

6/6 Peverell Street HILLCREST, QLD

3

1

6.8% RENTAL RETURN

6.8% is not a typo! Outstanding rental return, in a small complex, with LOW Body Corp fees! The paint has only just dried and its move in ready!

This townhouse provides a wonderful opportunity for the budget conscious. Offering so much more than you have come to expect.

With spacious tiled living and the bonus of a multipurpose room this wonderful family unit is set in a small complex. Favorably the complex is predominantly owner occupied, with 7 out of the 9 townhouses being owner occupy.

The open living area leads through to the full-size kitchen which has just received a nice face lift and looks out to the covered entertaining area and garden beyond.

Unlike most townhouses, there is even a back yard big enough for a small dog and complete with garden shed.

Upstairs offers so much space and one of the largest master bedrooms you will ever see in a unit complete with air-conditioning and double built-in robes.

Two other built-in bedrooms, hall storage, a family bathroom and separate toilet complete the upstairs.

Price:

All Reasonable Offers Considered



Griffiths & Gunn

0430445750



Approx. Area | Internal 113 m² | External 13 m² | Total 126 m²



UNLESS OTHERWISE STATED, ALL DIMENSIONS ARE IN METRES. THIS PLAN AND INFORMATION CONTAINED WITHIN IS FOR ILLUSTRATIVE PURPOSES ONLY AND NOT GUARANTEED TO BE EXACT. INTERESTED PARTIES SHOULD MAKE THEIR OWN ENQUIRIES.

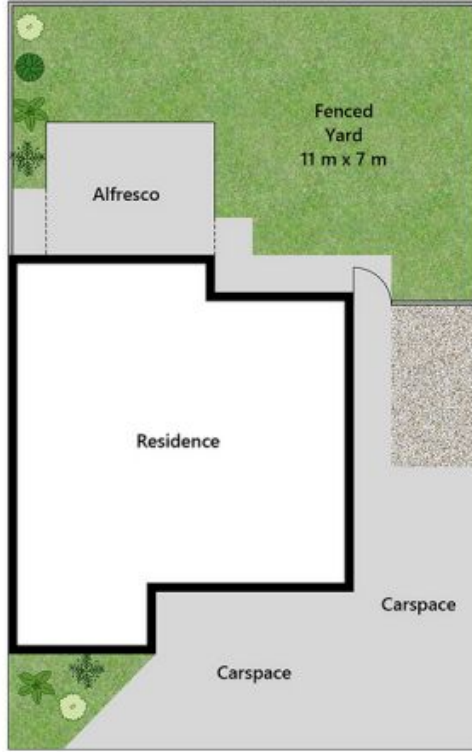

Lot Area 154 m²



UNLESS OTHERWISE STATED, ALL DIMENSIONS ARE IN METRES. THIS PLAN AND INFORMATION CONTAINED WITHIN IS FOR ILLUSTRATIVE PURPOSES ONLY AND NOT GUARANTEED TO BE EXACT. INTERESTED PARTIES SHOULD MAKE THEIR OWN ENQUIRIES.