



32 Gumview Close REGENTS PARK, QLD

4

2

1

### A HOME TO ENJOY

This lovely low maintenance 4-bedroom, 2-bathroom family home is set in a family friendly private close in the sought-after area of Regents Park.

Offering a master bedroom with ensuite and reverse cycle air-conditioning, spacious light filled lounge also with reverse cycle air conditioning, separate dining area, a functional modern kitchen with a breakfast bar and an abundance of cupboard space. Glass sliding doors lead out onto the covered patio area - a perfect place to entertain both family and friends overlooking the beautiful landscaped gardens.

There is a garden shed to accommodate all the garden tools and single gate side access via a concrete path.

Set in a great location this family home is within walking distance to Yugumbir School, bus stops, local shops, Grand Plaza shopping centre and a bus terminal. Only a short drive to the Mount Lindesay Highway and access to the major motorway links to Brisbane CBD and the Gold Coast.

**Price:**

High \$300,000's



**Claire Franklin**

0430 438 889



Approx. Floor Area | Internal 115 m<sup>2</sup> | External 42 m<sup>2</sup> | Total 157 m<sup>2</sup>

UNLESS OTHERWISE STATED, ALL DIMENSIONS ARE IN METRES. THIS PLAN AND INFORMATION CONTAINED WITHIN IS FOR ILLUSTRATIVE PURPOSES ONLY AND NOT GUARANTEED TO BE EXACT. INTERESTED PARTIES SHOULD MAKE THEIR OWN ENQUIRIES.



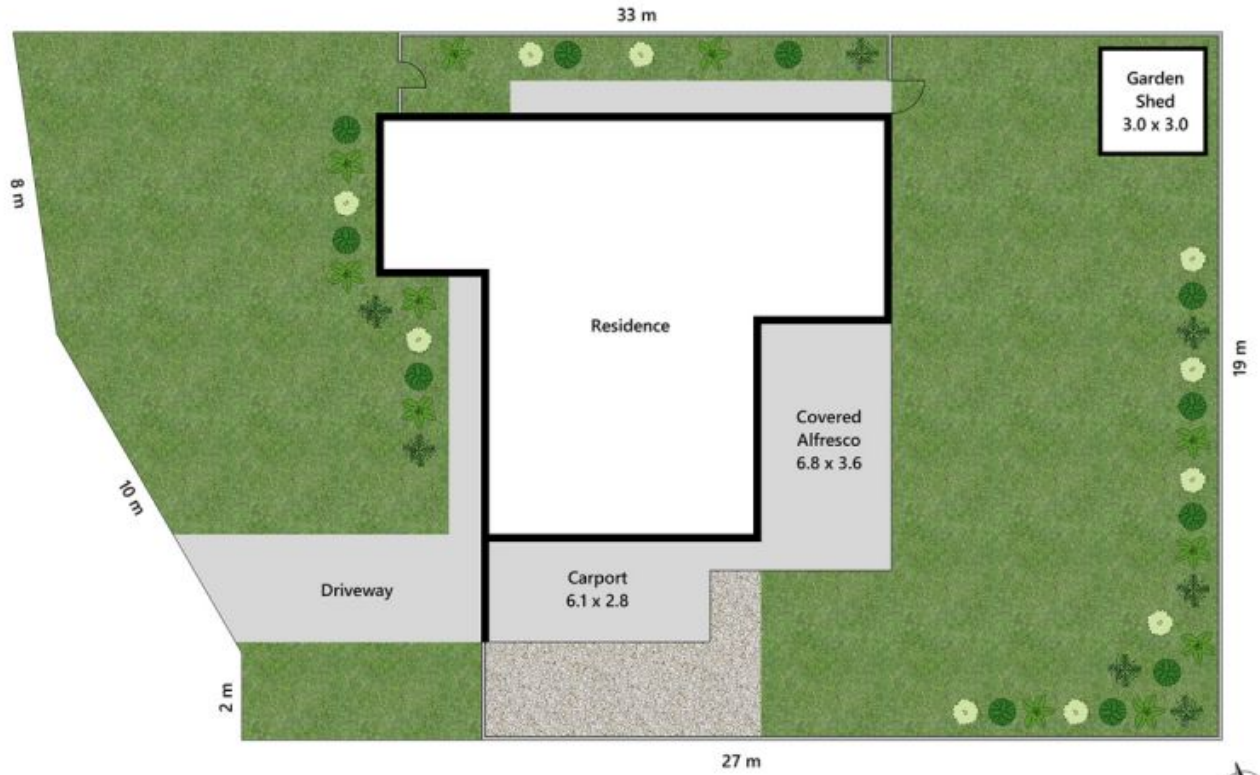

Lot Area | 600 m<sup>2</sup>

UNLESS OTHERWISE STATED, ALL DIMENSIONS ARE IN METRES. THIS PLAN AND INFORMATION CONTAINED WITHIN IS FOR ILLUSTRATIVE PURPOSES ONLY AND NOT GUARANTEED TO BE EXACT. INTERESTED PARTIES SHOULD MAKE THEIR OWN ENQUIRIES.