



your address

your address



your address REAL ESTATE

your address REAL ESTATE



your address REAL ESTATE

your address REAL ESTATE



your address REAL ESTATE

your address REAL ESTATE

18 Kimridge Drive HERITAGE PARK, QLD 4 4 4

WHEN SIZE REALLY DOES MATTER

This fantastic property is larger than the average family home and is situated in a quiet and peaceful cul-de-sac of Heritage Park. Offering a lifestyle of relaxation and comfort with great sized living space plus a study, 4 bedrooms and large covered entertaining area.

The modern kitchen is sure to please the most avid cook with an abundance of storage space including an additional butlers pantry perfect for storing the unwanted or less used kitchen gadgets.

The expansive light filled lounge is perfect for unwinding after a busy day, with reverse cycle air-conditioning and the glass doors bringing the beauty of mother nature in with the view overlooking the gorgeous rear yard and large covered patio area.

This really is a very special home and I know whoever buys it will love living here for many years as it has the space and comforts for your family to grow....

Price: Offers Over \$470,000



Claire Franklin

0430 438 889



Approx. Floor Area | Internal 215 m² | External 80 m² | Total 295 m²

UNLESS OTHERWISE STATED, ALL DIMENSIONS ARE IN METRES. THIS PLAN AND INFORMATION CONTAINED WITHIN IS FOR ILLUSTRATIVE PURPOSES ONLY AND NOT GUARANTEED TO BE EXACT. INTERESTED PARTIES SHOULD MAKE THEIR OWN ENQUIRIES.



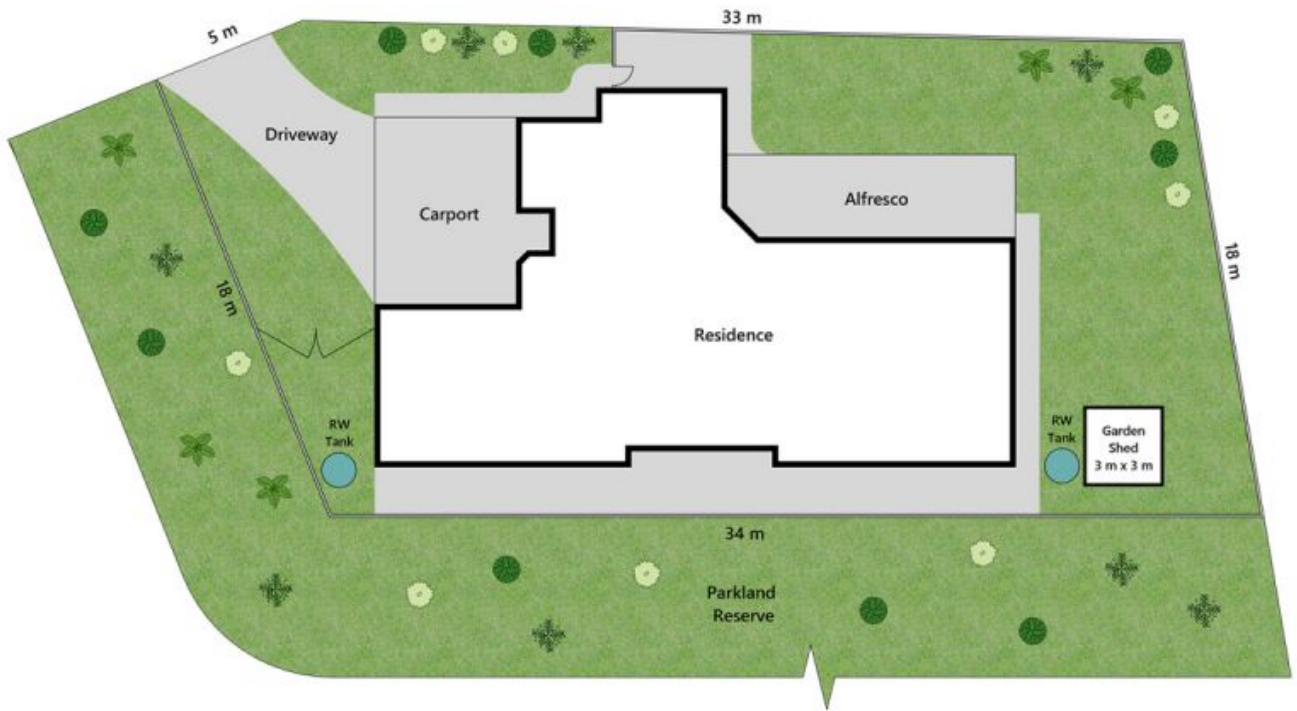

Lot Area | 651 m²

UNLESS OTHERWISE STATED, ALL DIMENSIONS ARE IN METRES. THIS PLAN AND INFORMATION CONTAINED WITHIN IS FOR ILLUSTRATIVE PURPOSES ONLY AND NOT GUARANTEED TO BE EXACT. INTERESTED PARTIES SHOULD MAKE THEIR OWN ENQUIRIES.

