



16 Spring Street Arncliffe, NSW

3 

2 

2 

Spacious north-facing semi

Move straight in, or renovate into a stunning contemporary home with character, and reap the rewards of this superb location.

Price:

Contact Agent



George Kambouroglou

0422 421 111



Tanios Azzi

0412 772 369

16 spring street
arncliffe

STONE

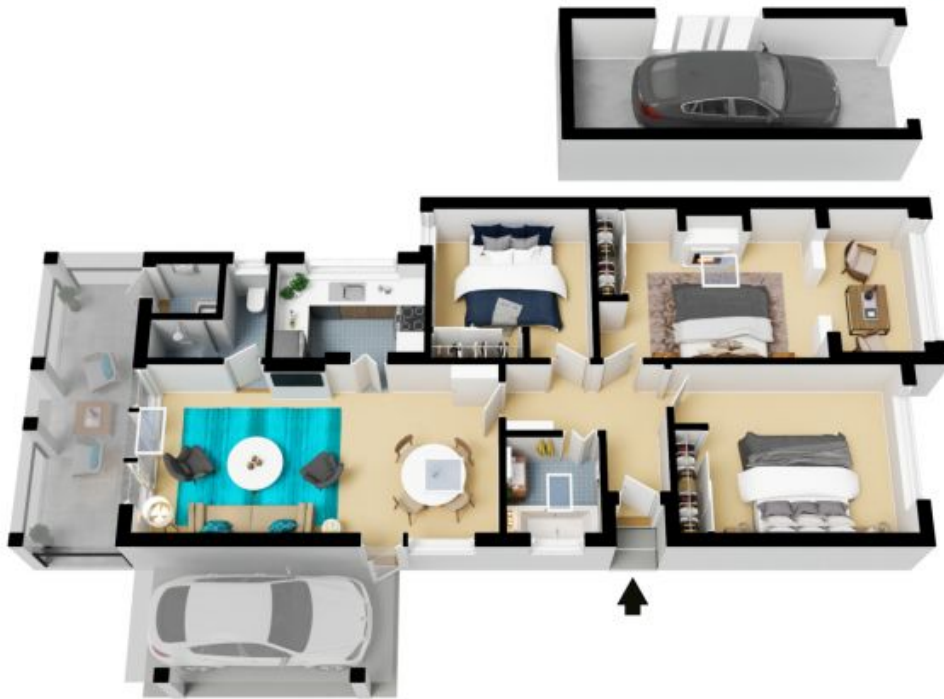

The floor plan is not to scale; measurements are indicative and in metres. All features included in this 3D plan are for inspiration purposes only. This is not an exact replica of the property or the position of exterior elements. Plans should not be relied on. Interested parties should make and rely on their own enquiries.

16 spring street
arncliffe



The floor plan is not to scale, measurements are indicative and in metres. Exterior elements are not in position. Plans should not be relied on, interested parties should make and rely on their own enquiries. All other information provided has been collected from reliable sources but cannot be guaranteed for accuracy.