



5 Napier Crescent North Ryde, NSW

6 

3 

2 

Modern stylish home on an expansive block

Wrapped in natural light this impressively scaled six-bedroom home is brimming in size with approx 350 Sqm of build area upon a child-friendly 714.5 Sqm block at located at the top of a quiet cul-de-sac. With a versatile layout perfect for large and extended families to entertain.

Price: Sold \$2,590,000

Council Rates: \$417.00 p/q

Water Rates: \$160.72 p/q



James Sarzano

0410 155 496

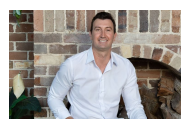

Jason Segon

0435 606 398



GROUND FLOOR

INTERNAL AREA: 349m²
 LAND SIZE: 714.5m²



FIRST FLOOR

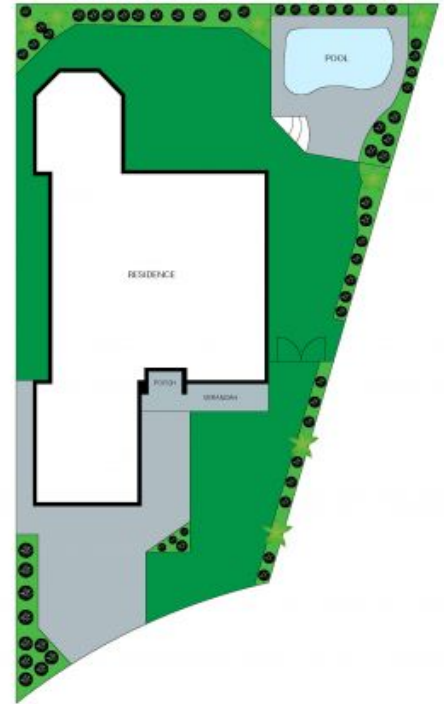

SITE PLAN



The floor plan is not to scale, measurements are indicative and in metres. Detail elements are not in position. Plans should not be relied on. Interested parties should make and rely on their own enquiries.

5 Napier Crescent, North Ryde

