



3/175 Gertrude Street Gosford, NSW



### Ideal Investment Opportunity

This conveniently located unit is only a short stroll to Gosford CBD, Rail Link, Hospital and Shopping Centre.

The property would be ideally suited to the first home buyer or astute investor.

Features include brand new carpet and fresh paint throughout, open plan lounge and dining area and storage area at the rear of the lock up garage.

Very affordable, ideal first property. Inspection highly recommended.

**Price:** Contact Agent  
**Council Rates:** \$1,089.00/year (approx)  
**Water Rates:** \$773.38/year (approx)



**Adrian Knight**

0410 407 188

3/175 Gertrude Street,  
Gosford

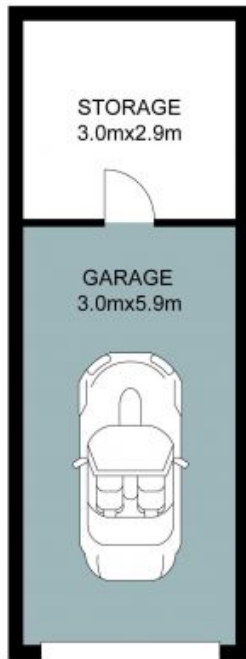

Not In Position

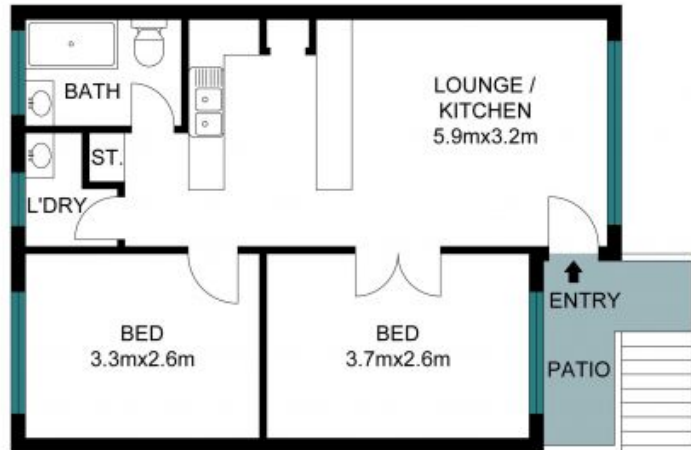

Ground Floor

The floor plan is not to scale; measurements are indicative and in metres. Plans should not be relied on. Interested parties should make and rely on their own enquiries. All other information provided has been collected from reliable sources but cannot be guaranteed for accuracy.

3/175 Gertrude Street,  
Gosford



The floor plan is not to scale; measurements are indicative and in metres. All features included in this 3D plan are for inspiration purposes only. This is not an exact replica of the property or the position of exterior elements. Plan should not be relied on. Interested parties should make and rely on their own enquiries.