



21 Killara Avenue Killara, NSW

4

3

2

**SOLD**  
Premier location with updated Art Deco

Graced with a blue-ribbon walk to rail address, this picturesque c.1930s brick home offers a family comfort with abundant Art Deco charm, and thoughtful modern updates with scope to make your own. Formal and casual living and dining areas provide versatility to use as you require. The covered deck enjoys easy in/out flow and a tranquil view to the thriving rear garden and pool. Kids will love the recreation space ideal for games, or a pool table.

Price:

Contact Agent



**Matt Payne**

0435 825 242



**Ryan Woo**

0410 884 680

21 Killara Avenue  
Killara



SITE PLAN

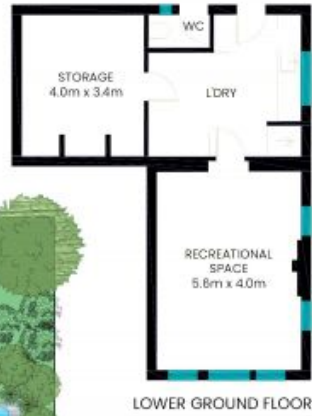

Internal area: 221m<sup>2</sup>  
Covered area: 26m<sup>2</sup>  
Total area: 247m<sup>2</sup>

The site plan and floor plan are not to scale; measurements are indicative and in meters. Bushes and trees are placed for illustration purposes. Plans should not be relied on. Interested parties should make and rely on their own enquire. All other information provided has been collected from reliable sources but cannot be guaranteed for accuracy.