

58 Princess Street Brighton-Le-Sands, NSW

3

1

1

### Spacious semi refreshed for modern bayside living

Located for lifestyle and smartly updated for today's living, this well-appointed period semi will delight bayside buyers with its spacious single-level layout and great convenience to all of Brighton-Le-Sands highlights. The property combines practicality with style and features plenty of original details, smart modern additions plus a good-sized rear garden for entertaining. It's also quietly tucked away in a boutique cul-de-sac that's just around the corner from Coles and the Bay Street dining precinct, with the beach at the end of the street.

Price:

SOLD \$1,495,000 | Ray Fadel



**Ray Fadel**

0413 177 739



**John Moustacas**

0416 335 256

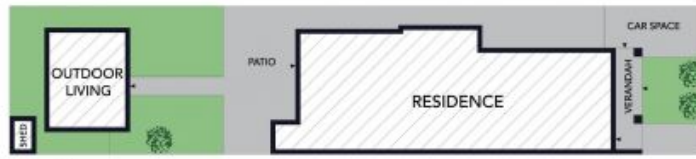

Site Plan



The site plan and floor plan are not to scale; measurements are indicative and in metres. Bushes and trees are placed for illustration purposes. Plans should not be relied on. Interested parties should make and rely on their own enquiries. All other information provided has been collected from reliable sources but cannot be guaranteed for accuracy.

58 Princess Street  
Brighton-Le-Sands



The floor plan is not to scale; measurements are indicative and in metres. All features included in this 3D plan are for inspiration purposes only. This is not an exact replica of the property or the position of exterior elements. Plans should not be relied on. Interested parties should make and rely on their own enquiries.