



502/95 West Esplanade Manly, NSW



Trophy harbourfront penthouse with stunning views

Anchored directly opposite Manly Cove with spellbinding harbour views, this top-of-the-range penthouse boasts an absolutely enormous wraparound entertainers' terrace that basks in northerly sunshine and drinks in shimmering harbour views. Occupying half of the top floor of an immaculate security building with private lift access, it features separate living and dining areas flowing to the terraces, superb appointments and two giant lock-up storerooms on title. Sheltered from the hustle and bustle yet footsteps from the beach at Manly Cove, it is only a few minutes stroll to Manly Wharf, shopping and cosmopolitan fine-dining restaurants.

Price:

Contact Agent



Adam Moore

0428 319 096



Mark Skeens

0401 241 381

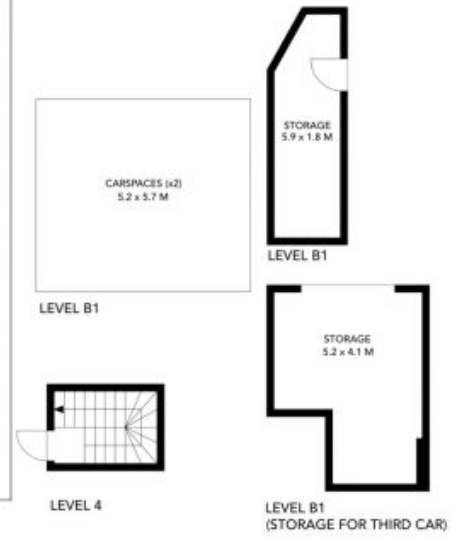

The floor plan is not to scale, measurements are indicative and in metres. Exterior elements are not in position. Plans should not be relied on, interested parties should make and rely on their own enquiries. All other information provided has been collected from reliable sources but cannot be guaranteed for accuracy.



The floor plan is not to scale; measurements are indicative and in metres. All features included in this 3D plan are for inspiration purposes only. This is not an exact replica of the property or the position of exterior elements. Plans should not be relied on. Interested parties should make and rely on their own enquiries.

