



15 Berrima Street Heathcote, NSW

4 2 2

Readymade family haven amid lush natural surrounds

Complementing relaxed modern interiors, with a leafy green backdrop, this welcoming family home is ready to move in without a cent more to spend. A prized rear north aspect embraces an abundance of natural light through the flowing layout, capturing expansive outlooks across the Woronora Valley from multiple viewpoints. Comfortable living offered from four spacious bedrooms and ample storage space. Nature and wildlife right at your feet with beautiful surrounding trails through the national park, and walking distance from Heathcote Station.

Price: \$1,250,000
Council Rates: \$435.40 p/q
Water Rates: \$160.00 p/q



Rhys Christofa

0415 684 877



Ezra Malolo

0401 490 024

15 Berrima Street
Heathcote



Site Plan



Upper Floor



Lower Floor



The site plan and floor plan are not to scale; measurements are indicative and in metres. Bushes and trees are placed for illustration purposes. Plans should not be relied on. Interested parties should make and rely on their own enquiries. All other information provided has been collected from reliable sources but cannot be guaranteed for accuracy.

15 Berrima Street
Heathcote



Upper Floor

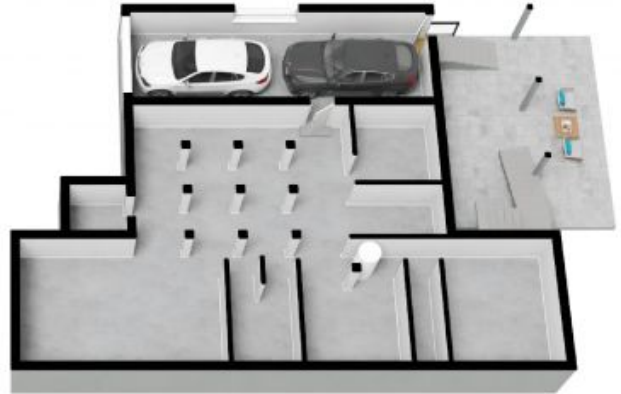

Lower Floor



The floor plan is not to scale; measurements are indicative and in metres. All features included in this 3D plan are for inspiration purposes only. This is not an exact replica of the property or the position of exterior elements. Plans should not be relied on. Interested parties should make and rely on their own enquiries.