



6 Camelot Close Mount Colah, NSW

6 5 2

Sold by Dean and Di Finch - for further details please call

Commanding a premier location in a quiet and tranquil cul-de-sac, surrounded by lush landscapes. This home has an impressive dual-level layout and sophisticated finishes throughout, the home offers multiple living spaces for the growing family including a complete in laws/ teenage retreat fitted with a full kitchen & two bedrooms that flows to the alfresco decking. The five bedrooms throughout all have built-in robes & two master bedrooms with walk in robes & en-suites.

Price: Sold by Dean and Di Finch
Council Rates: \$482.60 p/q
Water Rates: \$160.18 p/q



Dean Finch

0425 214 866



Di Finch

0425 226 180

6 Camelot Close
Mount Colah

STONE



Internal Living: 387 sqm
External Living: 106 sqm
Total Living Area: 493 sqm

Ground Floor

1st Floor



The floor plan is not to scale; measurements are indicative and in metres. All features included in this 3D plan are for inspiration purposes only. This is not an exact replica of the property or the position of exterior elements. Plans should not be relied on. Interested parties should make and rely on their own enquiries.

6 Camelot Close
Mount Colah

STONE

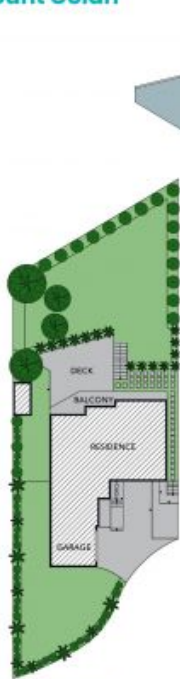

Site Plan



Ground Floor



1st Floor

Internal Living: 387 sqm
External Living: 106 sqm
Total Living Area: 493 sqm



The site plan and floor plan are not to scale; measurements are indicative and in metres. Bushes and trees are placed for illustration purposes. Plans should not be relied on. Interested parties should make and rely on their own enquiries. All other information provided has been collected from reliable sources but cannot be guaranteed for accuracy.