



27 Mossman Avenue Bateau Bay, NSW



Spectacular coastal home

Price:

Contact Agent



Shanti Santhou

0437787221



Jake Smith

0423 284 610

27 Mossman Avenue ,
Bateau Bay

STONE

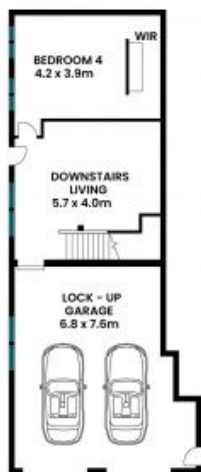

Lower Level



Entry Level



Site Plan

Internal Area: 275sqm



The site plan and floor plan are not to scale; measurements are indicative in meters. Bushes and trees are places for illustration purposes. Plans should not be relied on. Interested parties should make and rely on their own enquiries. All other information provided has been collected from reliable sources but cannot be guaranteed for accuracy.