



15/11-13 Rowe Street Freshwater, NSW 1  1  1 

Oversized top floor apartment in a prime location

One of the largest one bedroom apartments you're likely to see, this bright and spacious residence provides an instantly liveable haven while offering optional scope to stamp your own creative mark and further capitalise. Placed on the top floor with only two flights of access stairs, it is only 230m to buses travelling to Manly Beach and Wharf, Warringah Mall and express to the city and within a stroll of Manly Lagoon, Queenscliff Beach or Freshwater Village and Beach.

Price:

Contact Agent



Catherine Wilson

0421 966 570



Tim Mumford

0421 942 693

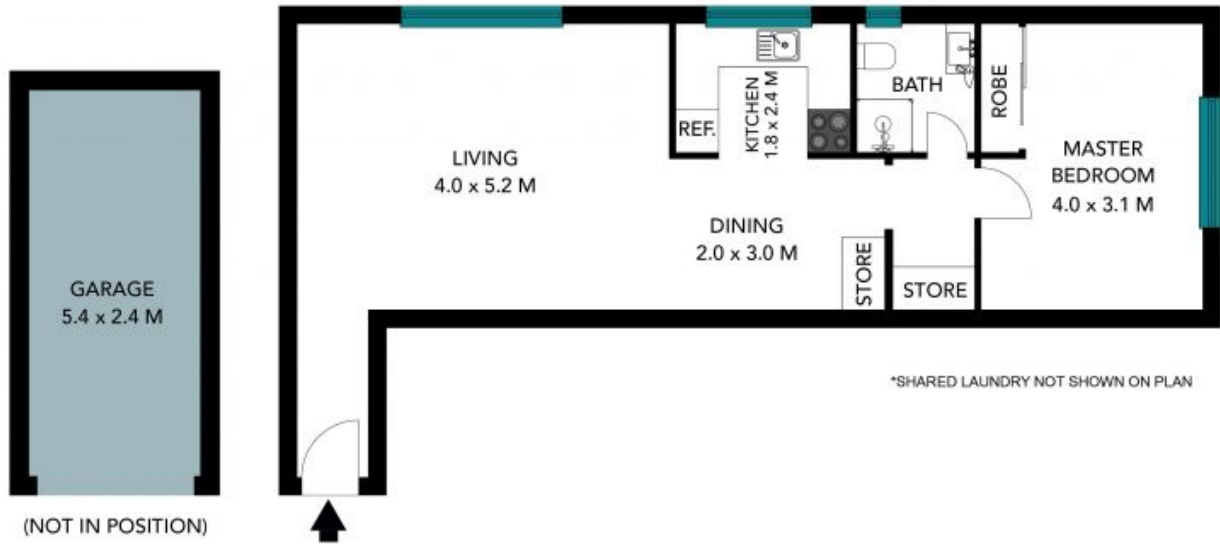

15/11 Rowe Street
Freshwater



The floor plan is not to scale; measurements are indicative and in metres. All features included in this 3D plan are for inspiration purposes only. This is not an exact replica of the property or the position of exterior elements. Plans should not be relied on. Interested parties should make and rely on their own enquiries.