



137/51-54 The Esplanade Ettalong Beach, NSW 1

Ideal beachside lifestyle investment!

This West-facing studio apartment located in the heart of Ettalong Beach represents the ideal lifestyle investment. Enjoy resort style living for yourself and earn an income when you're not enjoying all that Ettalong Beach has to offer!

Ideally located just walking distance from Ettalong beach, town centre, local shops & restaurants and Palm Beach ferry, this one is not to be missed!

- Price:** \$360,000
- Council Rates:** \$1,089.00/year (approx)
- Water Rates:** \$773.40/year (approx)
- Strata Rates:** \$607.80 p/q



Zen Frediani
0499 266 252



Christel Renton
0417 208 314

137/51-54 The Esplanade
Ettalong Beach

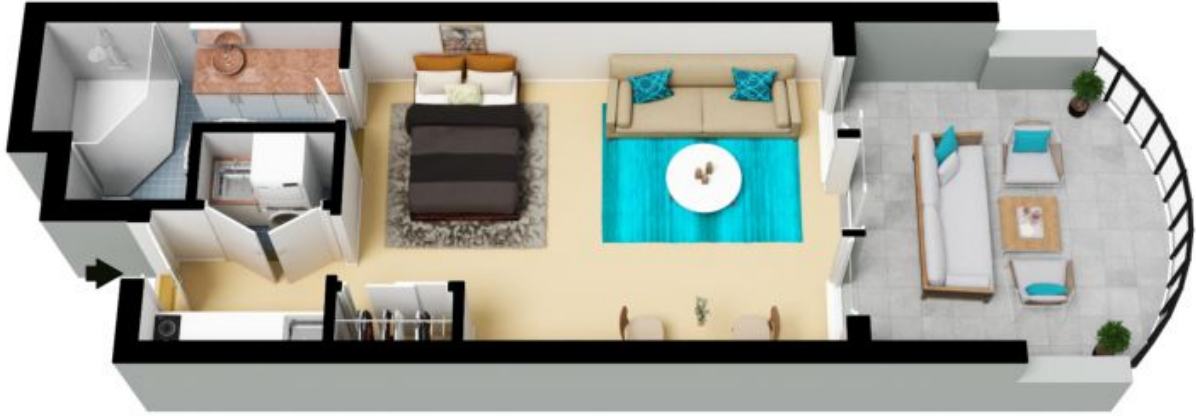

The floor plan is not to scale; measurements are indicative and in metres. All features included in this 3D plan are for inspiration purposes only. This is not an exact replica of the property or the position of exterior elements. Plans should not be relied on. Interested parties should make and rely on their own enquiries.

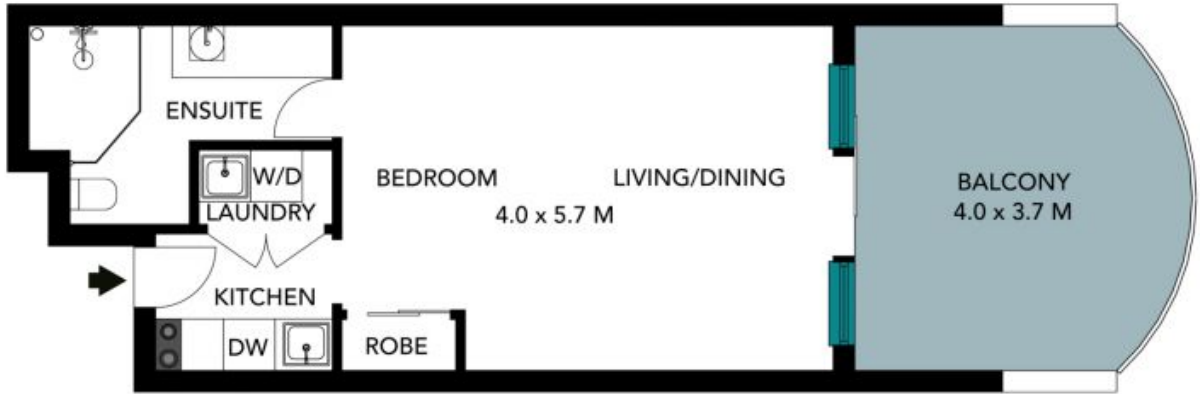

The floor plan is not to scale, measurements are indicative and in metres. Exterior elements are not in position. Plans should not be relied on, interested parties should make and rely on their own enquiries. All other information provided has been collected from reliable sources but cannot be guaranteed for accuracy.