



21/2a Campbell Parade Manly Vale, NSW

3 2 2

Designer apartment in tightly-held 'Augusta' complex

Ultra-quiet and private, with a tranquil leafy outlook over the manicured greens of Warringah Golf Course, this luxury apartment promises a relaxed, easy lifestyle in a location that offers convenient access to transport, shopping, dining and beaches. Boasting an ideal rear-to-north aspect and with 170sqm on title, the home is set over two light-drenched levels with wide sunny terraces on each.

- Open plan living/dining with wall-to-wall bi-fold doors to wide north-facing entertaining terrace
- Sleek modern gas kitchen with Miele appliances and generous Caesarstone breakfast bar
- Luxe parents' retreat upstairs with private balcony, ensuite, walk-in robe and adjoining study/living
- Separate laundry adjacent to kitchen; ducted air conditioning throughout
- Family bathroom with granite-top vanity plus separate bath and shower
- Two good-sized bedrooms, both with built-in robes
- Remote-access secure underground double garaging

Price: Contact Agent
Council Rates: \$403.00 p/q
Water Rates: \$147.00 p/q



Chris Elliott

0410 416 066



Jessica Fedrigo

0404 989 070

STONE

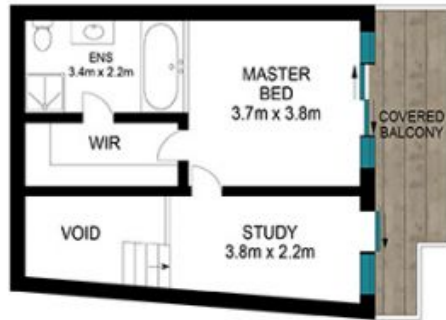
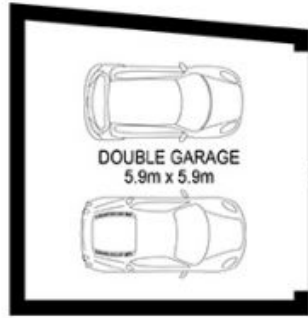
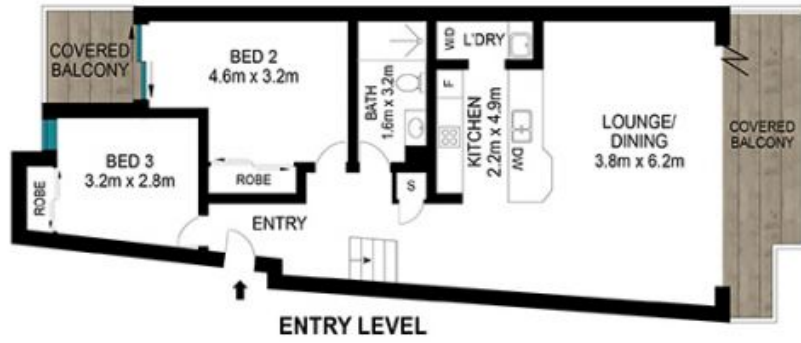

0 1 2 3 4 5

Scale in metres. Indicative only. Dimensions are approximate. All information contained herein is gathered from sources we believe to be reliable. However, we cannot guarantee its accuracy and interested persons should rely on their own enquiries.



21/2A Campbell Pde, Manly Vale