

162 Crystal Palace Way Leppington, NSW      4       2       1 

**Family Style living**

\*PLEASE NOTE - TURN OFF GUILD AV IN LEPPINGTON FOR THE CORRECT LOCATION\*

Price:

Contact Agent



**Chris York**

0405 434 414



**Markos Siotis**

0419 725 397



Ground Floor

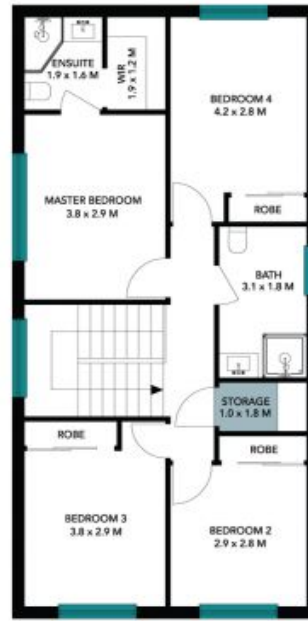

First Floor



The floor plan is not to scale; measurements are indicative and in metres. Exterior elements are not in position. Plans should not be relied on. Interested parties should make and rely on their own enquiries. All other information provided has been reflected from reliable sources but cannot be guaranteed for accuracy.

162 Crystal Palace Way  
Leppington



Ground Floor



First Floor



The floor plan is not to scale; measurements are indicative and in metres. All features included in this 3D plan are for inspiration purposes only. This is not an exact replica of the property or the position of exterior elements. Plans should not be relied on. Interested parties should make and rely on their own enquiries.