

STONE



1161 Burragarang Road Belimbla Park, NSW

3 

1 

10 

The one you have been waiting for!

Look no further than 1161 Burragarang Road, Belimbla Park. Conveniently located just a short leisurely drive to the heart of Camden, this is the perfect start for your life on property with ample space for the growing family.

Price: \$1,460,000



Anthony Grima

0421 228 414



Rebecca Philp

0403 613 271



The floor plan is not to scale, measurements are indicative and in metres. Extra elements are not in position. Plans should not be relied on. Interested parties should make and rely on their own enquiries. All other information provided has been collected from reliable sources but cannot be guaranteed for accuracy.

1161 Burragarong Road, Belimba Park

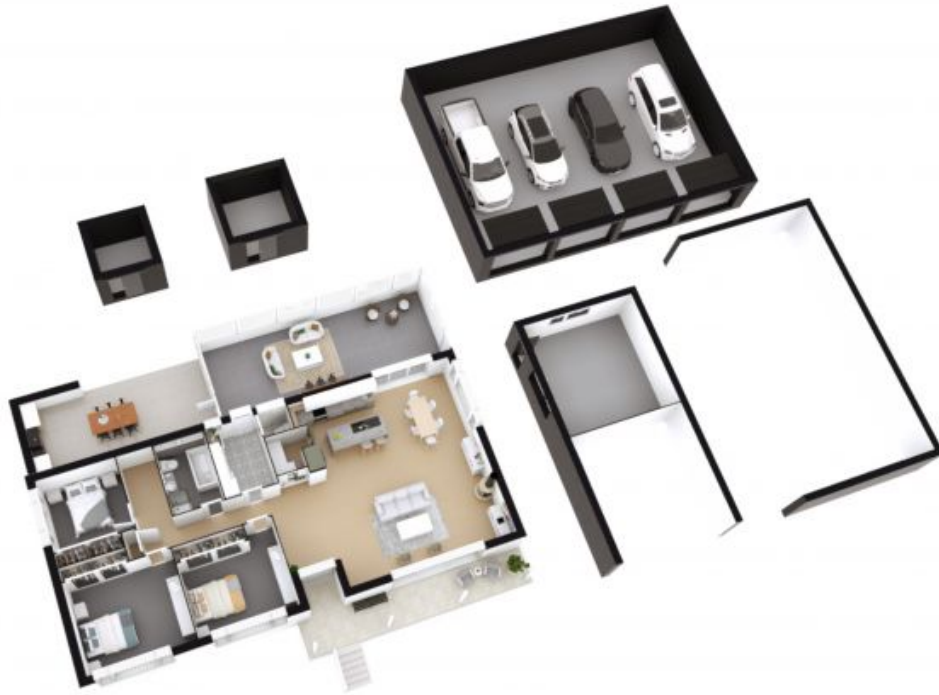

The floor plan is not to scale; measurements are indicative and in metres. Extra lot elements are not in position. Plans should not be relied on. Interested parties should make and rely on their own enquiries. All other information provided has been collected from reliable sources but cannot be guaranteed for accuracy.

1161 Burragarong Road, Belimba Park