

26 Sirius Avenue Bateau Bay, NSW

4

2

2

Coastal Glamour

Welcome home to 26 Sirius Avenue, step inside and be greeted by a spacious and open floor plan, modern finishes, and an abundance of natural light. Boasting single level living that provides longevity for those looking to downsize or a young family wanting to upgrade without compromising on space.

The brand-new kitchen is a standout feature of the home and has a great connection to the outdoor area making entertaining a breeze. Multiple living and dining areas create a space for everyone in the family to work and relax. This truly is a quality home in a great area and won't disappoint.

Price:

Contact Agent



Shanti Santhou

0437787221

26 Sirius Avenue,
Bateau Bay

STONE



Residence

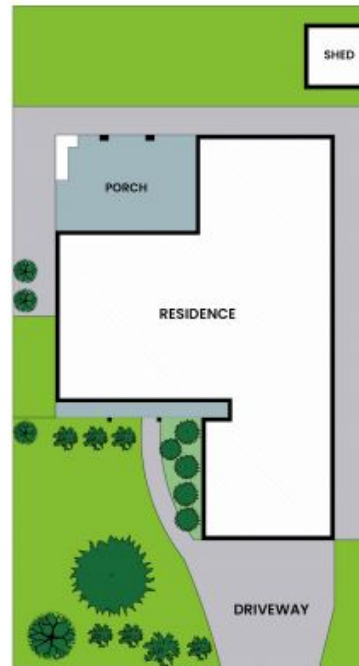

Site Plan

Internal Area: 148sqm
External Area: 77sqm

PLEASE NOTE: These Floor Plan + Site Plans have been generated for marketing purposes and are to be used as a guide only. While all care is taken, no guarantee can be given in respect of accuracy, sizes and dimensions are approximate, actual may vary.