



18 Robertson Street Greenwich, NSW

5

3

2

Sold By Stone Greenwich

Rarely does the opportunity arise to secure property of this calibre, privately placed as one of only 19 exclusive residences to share the waterfront in Greenwich, on a stunning 1341 sqm (approx). Nestled in an intimate cul-de-sac, the property spans to the water's edge incorporating terraced gardens and private access to a beach.

Hidden beyond a walled and gated exterior and north-east facing, the solid full brick home sits on a sandstone base, embracing magnificent panoramas over Woodford Bay, the Lane Cove River, Woolwich and the city skyline. Elegant and light filled, it can be instantly enjoyed, renovated or extended or with no conservation, removed and replaced (STCA).

- Dress Circle setting, private direct waterfront with stunning Lane Cove River, Woolwich and City Views.
- Large stone kitchen with breakfast bench.
- Flexible separate entry lower level multi purpose room.
- Covered access DLUG with storage.

All information contained herein is gathered from third party sources we deem to be reliab...

Price:

Contact Agent



Chris Keane

0497 102 114



Bernadette Hayes

0431 558 505

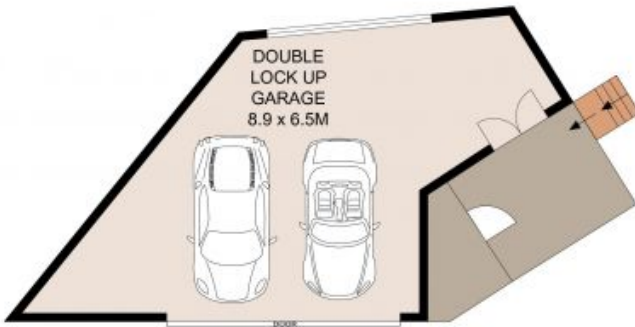

GROUND FLOOR

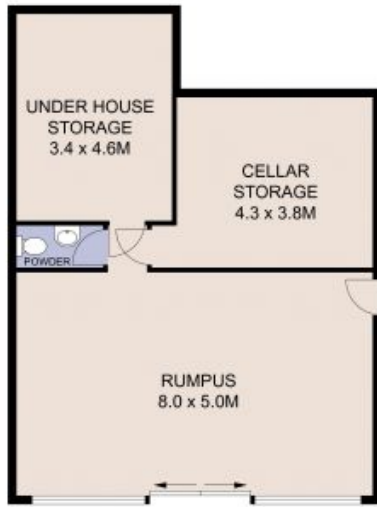

LOWER GROUND FLOOR

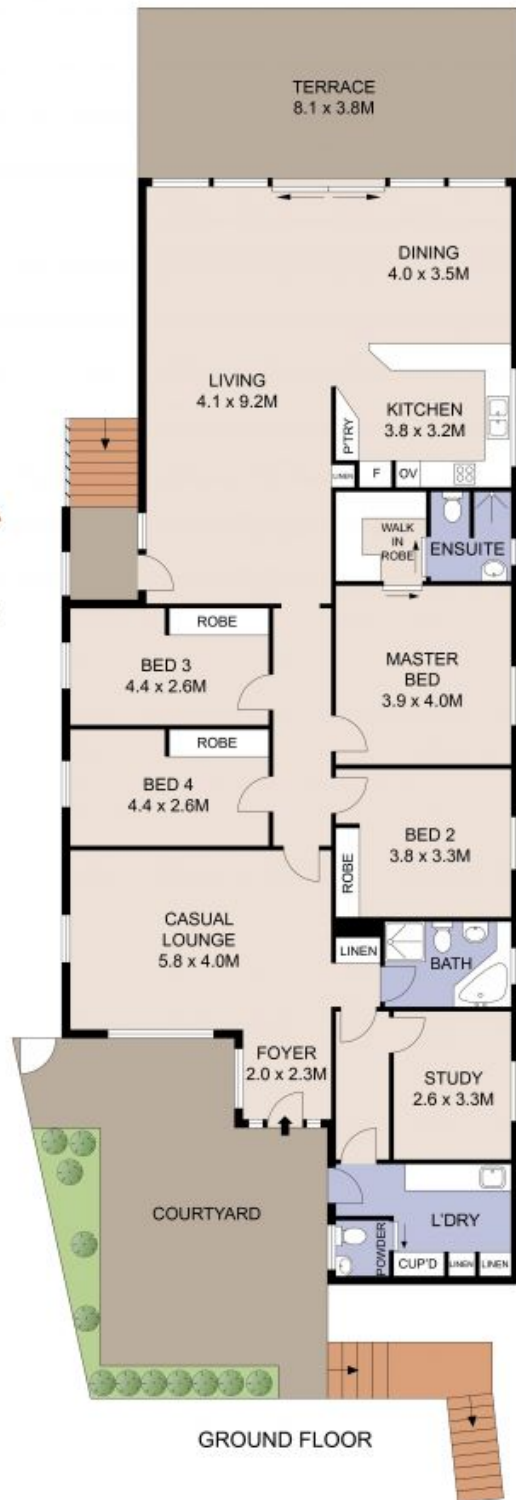

GROUND FLOOR



Plans shown are for presentation purposes only and are not part of any legal document or title. They are subject to errors, omissions, inaccuracies and should not be used as a sole and accurate reference. Interested parties should make their own inquiries using independent sources.

18 ROBERTSON STREET

GREENWICH



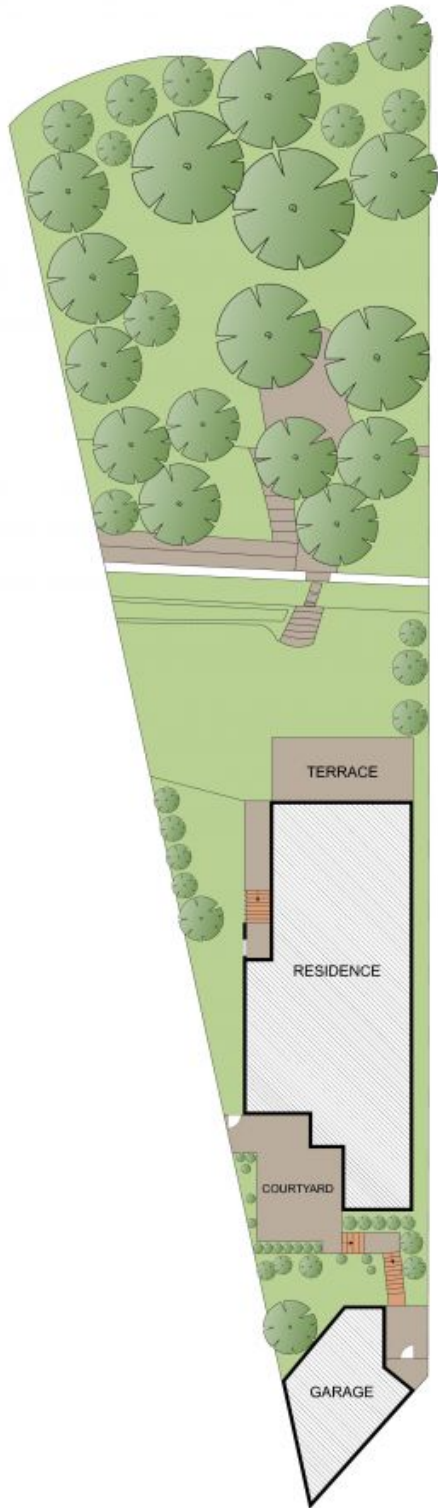

SITE PLAN
(NOT TO SCALE)



Plans shown are for presentation purposes only and are not part of any legal document or title. They are subject to errors, omissions, inaccuracies and should not be used as a sole and accurate reference. Interested parties should make their own inquiries using independent sources.

18 ROBERTSON STREET

GREENWICH