

15 Gyp Court KALLANGUR, QLD

4

1

2

2

### Large Family Home! Cul-De-Sac Location!

Large Family Home! Cul-De-Sac Location!

Price:

All Offers From \$700,000



**Team Doyle**

0414 666 536



**Dee Doyle**

0407 725 626

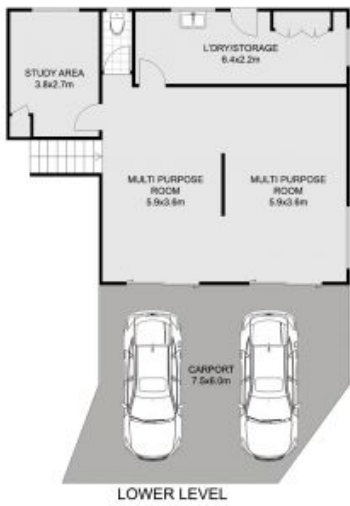

# 15 Gyp Court, Kallangur

Estimated Int area : 231sqm  
Estimated Ext area : 100sqm



The floor plan is not to scale; measurements are indicative and in metres. Exterior elements are not in position. Plans should not be relied on. Interested parties should make and rely on their own enquiries.