



1/29 Kingsclare Street Leumeah, NSW 2 1 2

Superb Location

- * Delightful townhouse in a superior location
- * 2 bedrooms with built-in robes
- * Spacious lounge and dining
- * Single lock-up garage with internal access
- * Low maintenance fully fenced courtyard
- * Street frontage, all set in a boutique small complex
- * 850m to Leumeah Train Station, shops and Clubs
- * Ideal for the investor or first home buyer

Price: \$419,950

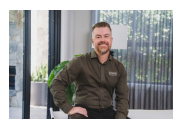

Gary Luke

0418 451 105



R&W
Campbelltown

AGENT - GARY LUKE
MOBILE - 0418 451 105

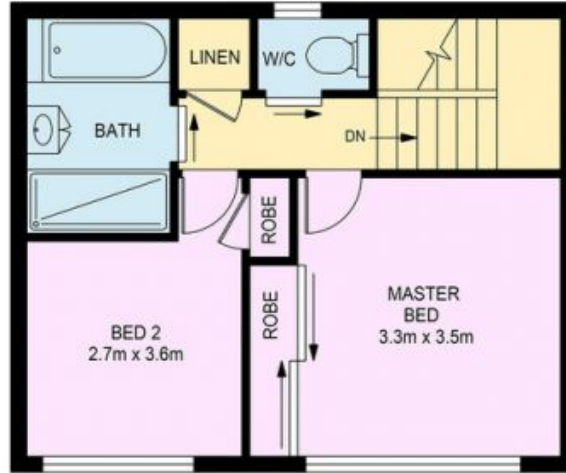

LEVEL 2 FLOOR PLAN

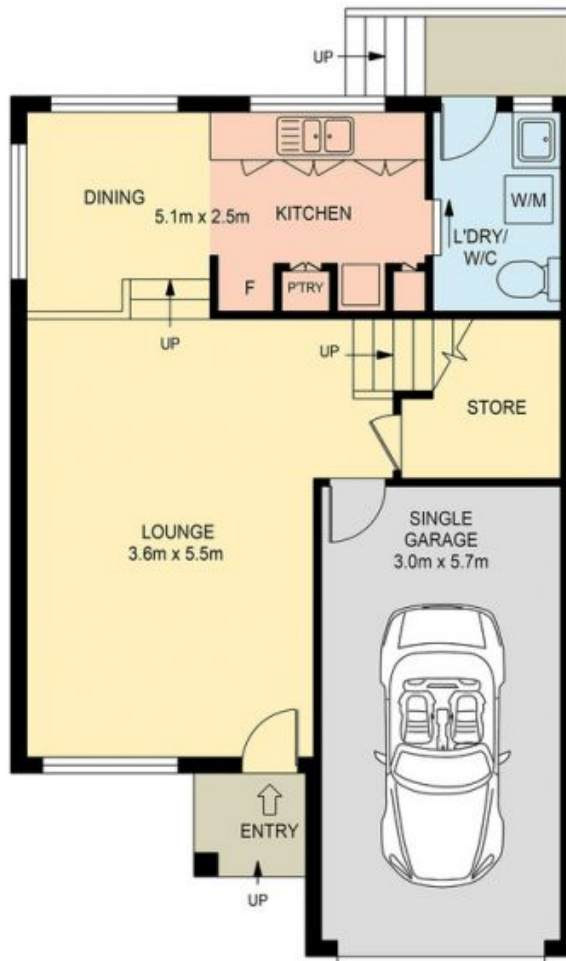

LEVEL 1 FLOOR PLAN

UNIT 1, 29 KINGSCLARE STREET, LEUMEAH

Disclaimer: Floor and Site Plans are intended to give a general indication of the proposed layout only. No guarantee is given in respect of its accuracy. Any person viewing this information should make their own enquiries and only rely on these enquiries.

