



220 The Parkway Bradbury, NSW

4 1 2

Sold By Josh Mayo - \$500,000!

Price: \$510,000 - \$540,000

- * Great entry level opportunity or renovator prospect
- * Close to schools, shops, public transport and amenities
- * Ideal location of popular family orientated suburb
- * Four bedrooms, built-ins to two, second toilet
- * Updated kitchen with separate dining or meals area
- * Corner block position on 558m2 parcel of land

Stone Real Estate

(02) 4625 0201
Macarthur

Campbelltown

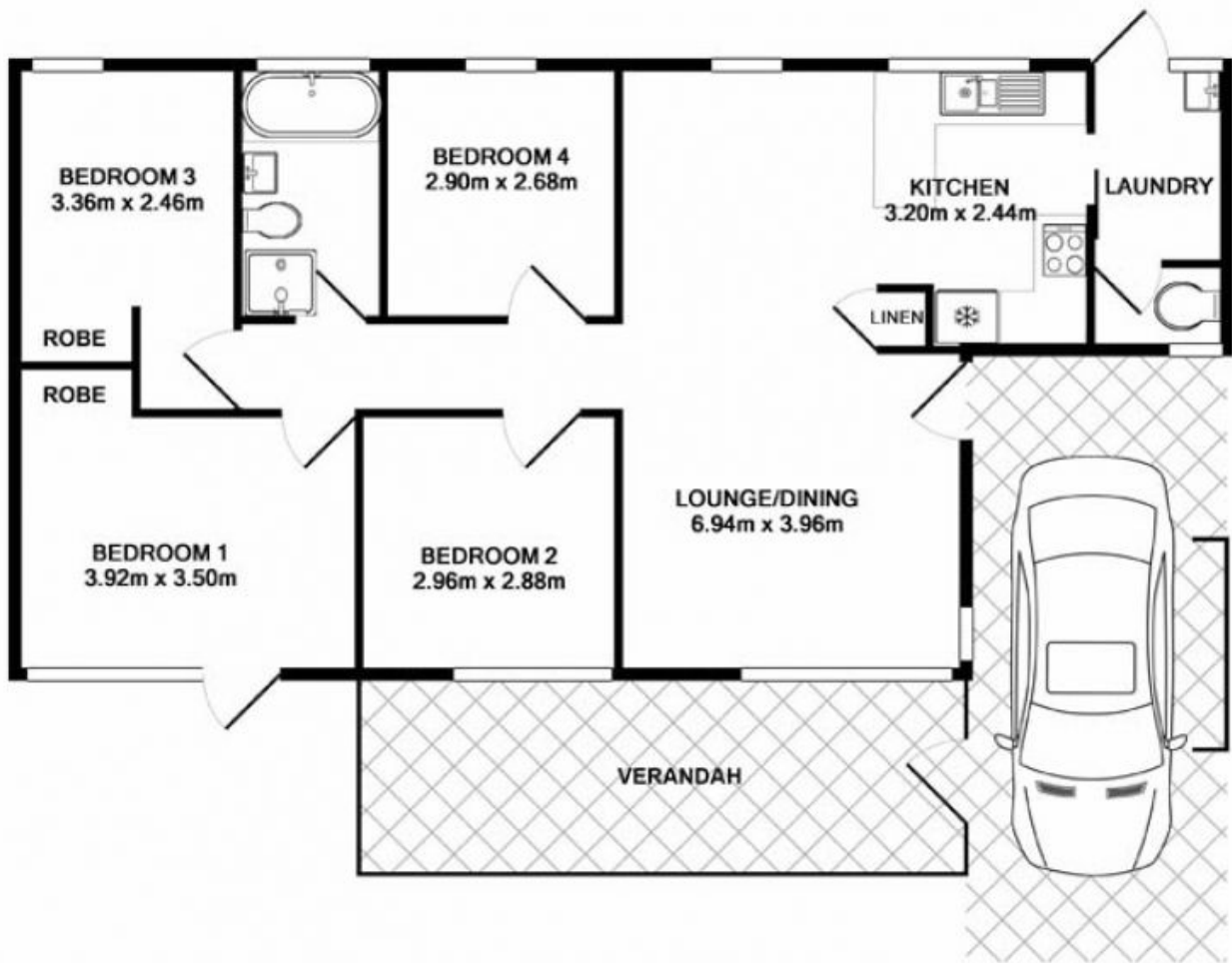

Measurements are approximate. Not to scale. Illustrative purposes only