

13/47 Stowe Avenue Campbelltown, NSW 2 2 2

SOLD BY MICHELLE BALABKA & RUSSELL WYER - \$535,000

Price: \$530,000 - \$550,000

- * Lovely open plan second floor apartment
- * Large 20m2 enclosed terrace
- * South Easterly position with bush reserve outlook
- * Combined Living, kitchen and dining area with floor to ceiling glazing
- * Both bedrooms open onto the outdoor terrace
- * The kitchen boasts 'BOSCH' appliances including dishwasher and Caesarstone bench tops
- * This apartment will suit owner occupiers or downsizing from a larger home
- * Security parking with caged storage and lift access is provided
- * The position is walking distance to Macarthur Square shopping centre and Railway Station, movies and restaurant precinct as well as Campbelltown Golf Course Fairways
- * Very unique in size, presents as new. Be the first to inspect this highly desirable apartment!!



Michelle Balabka
0419 473 253

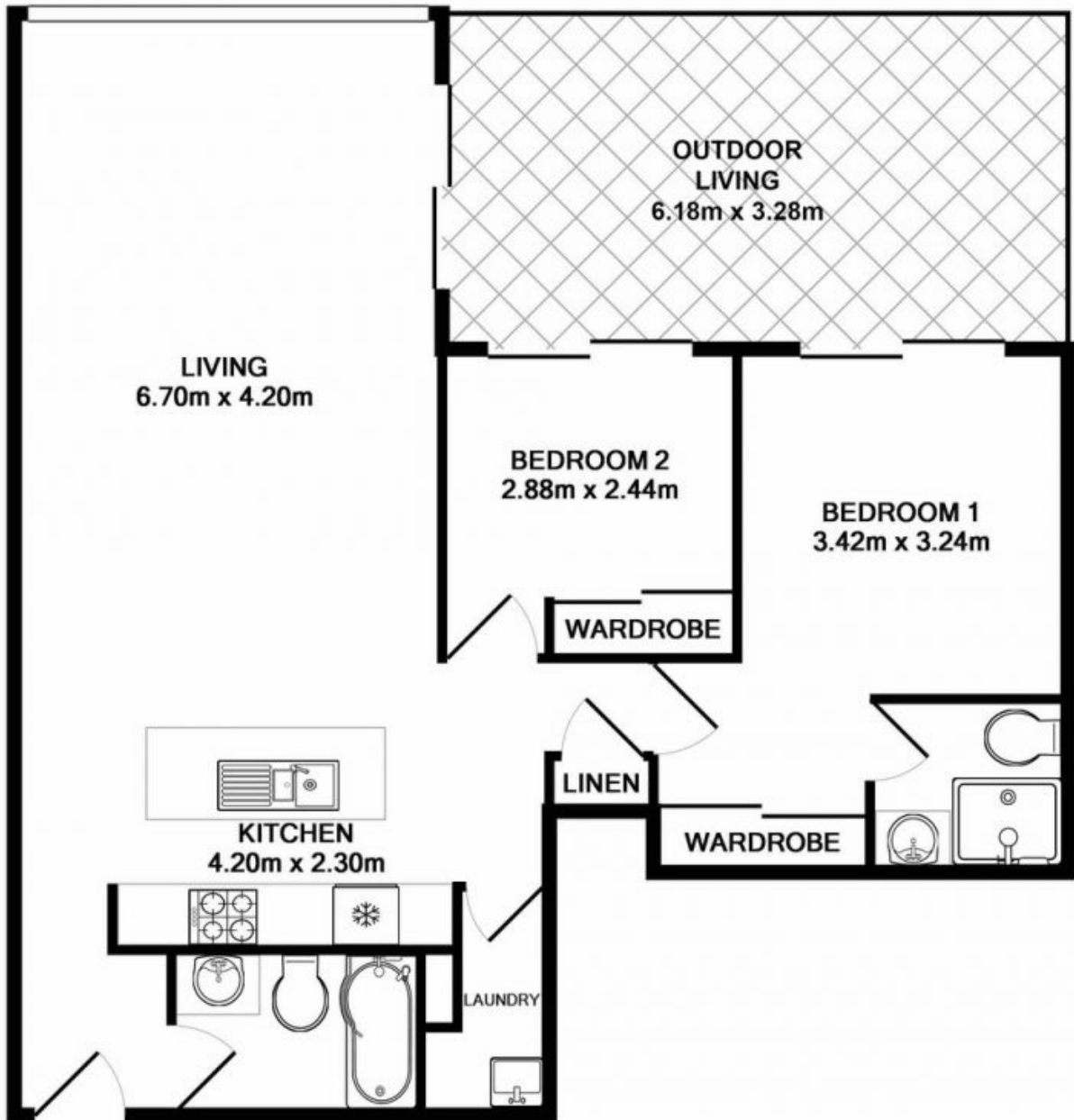

Measurements are approximate. Not to scale. Illustrative purposes only