

STONE



23/47 Stowe Avenue Campbelltown, NSW

2 

2 

2 

**SOLD BY RUSSELL WYER & MICHELLE BALABKA - \$528,000**

**Price:** \$539,950

- \* Fourth floor two bedroom apartment located in the 'Stowe Apartment' Complex
- \* Split system air conditioning to the lounge and dining area
- \* Large wrap around balcony with views towards the University and Botanical gardens
- \* Built-in robes to both bedrooms, en-suite bathroom to the master bedroom
- \* 'Bosh' 600mm stainless steel kitchen appliances and stone bench tops
- \* Internal laundry with dryer, internal storage room and secure underground parking
- \* Located within 500m to Macarthur Railway station, Macarthur Square shopping precinct including restaurants and cinema
- \* Western Sydney University campus and Campbelltown hospitals are all within a 1km radius. This is a very desirable location for owner occupiers and investors alike!!



**Russell Wyer**

0414 867 707

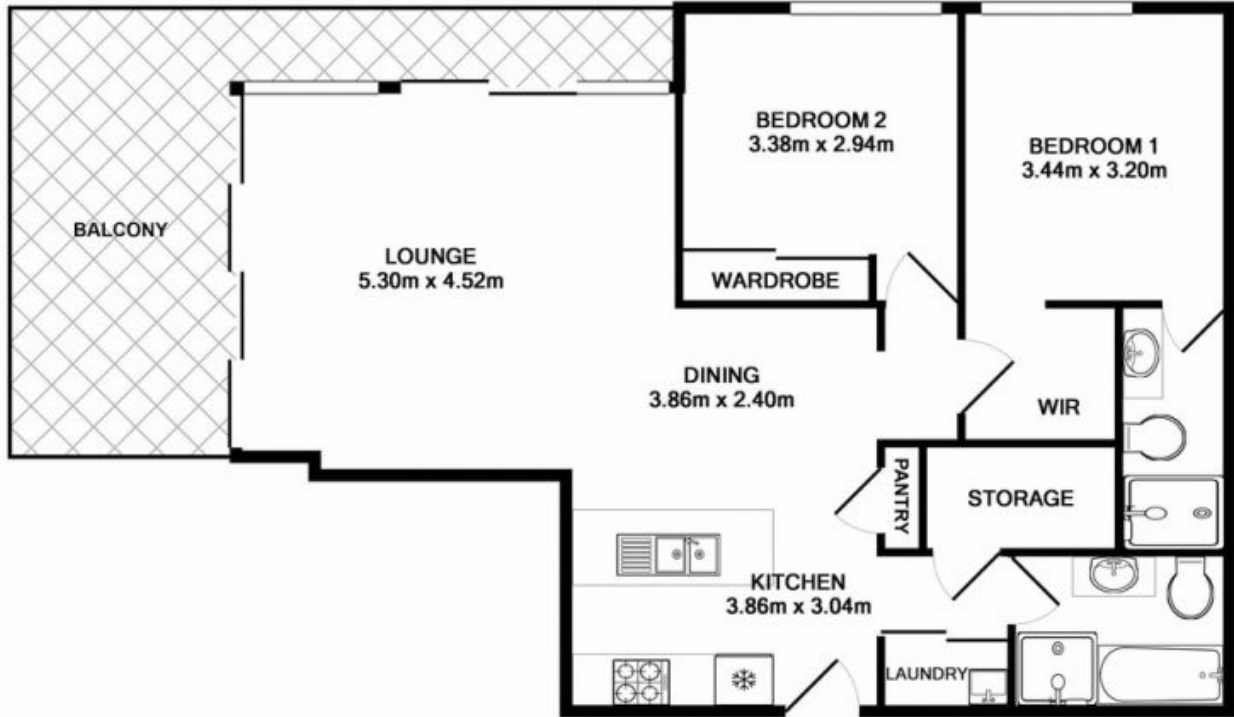

Measurements are approximate. Not to scale. Illustrative purposes only