

1/94 Epping Forest Drive Kearns, NSW 2 1 2

**SOLD BY RUSSELL WYER / MICHELLE BALABKA**

Duplex Home

- \* Beautifully appointed courtyard home conveniently located within 100m of the local shops, primary school and bus stop
- \* Hardwood timber flooring feature throughout the open plan living and family room areas
- \* A delightful rear courtyard with outdoor pavilion further extends the indoor outdoor living options
- \* Other features include two x split air conditioning systems, electric security shutters to all windows, 2nd toilet, built in robes and landscaped gardens
- \* Ideally suit first home buyer, young professional or empty nester looking for low maintenance, convenience and a northern suburbs location with easy access to Sydney's motorway network

**Price:**

Asking Price \$479,950



**Russell Wyer**

0414 867 707

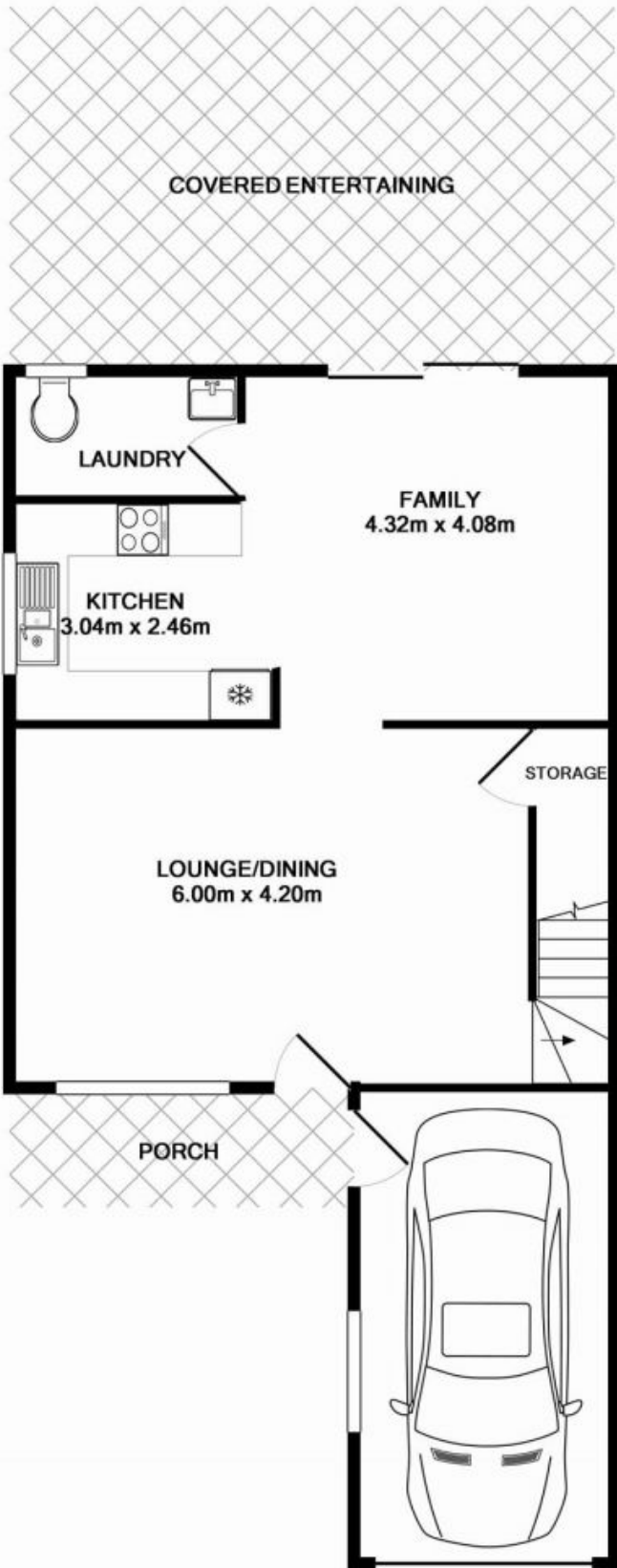

GROUND FLOOR

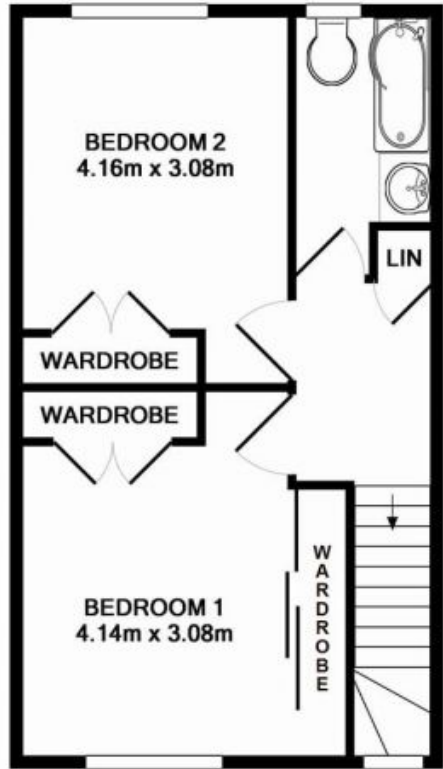

1ST FLOOR