



STONE

Leumeah Train Station

Shops

Wests Leagues Club

822sqm



15m frontage

822sqm



15m frontage

822sqm



2 Onslow Place Leumeah, NSW

3 1

SOLD BY ANTHONY BEKIARIS - \$553,000

Price: \$560,000

Possible Development Site (S.T.C.A) 822sqm Block Of Land + 400m Walk To Leumeah Train Station.

Enormous Parcel of land located within only a moments walk to Leumeah Train Station and shops

Three bedroom brick home with lounge and dining areas

R/C air conditioning

Large side access

Possible duplex site (Subject to Council Approval)

822sqm block of land + 15m frontage

A fantastic a rare opportunity not to be missed

**Stone Real Estate -
Head Office**

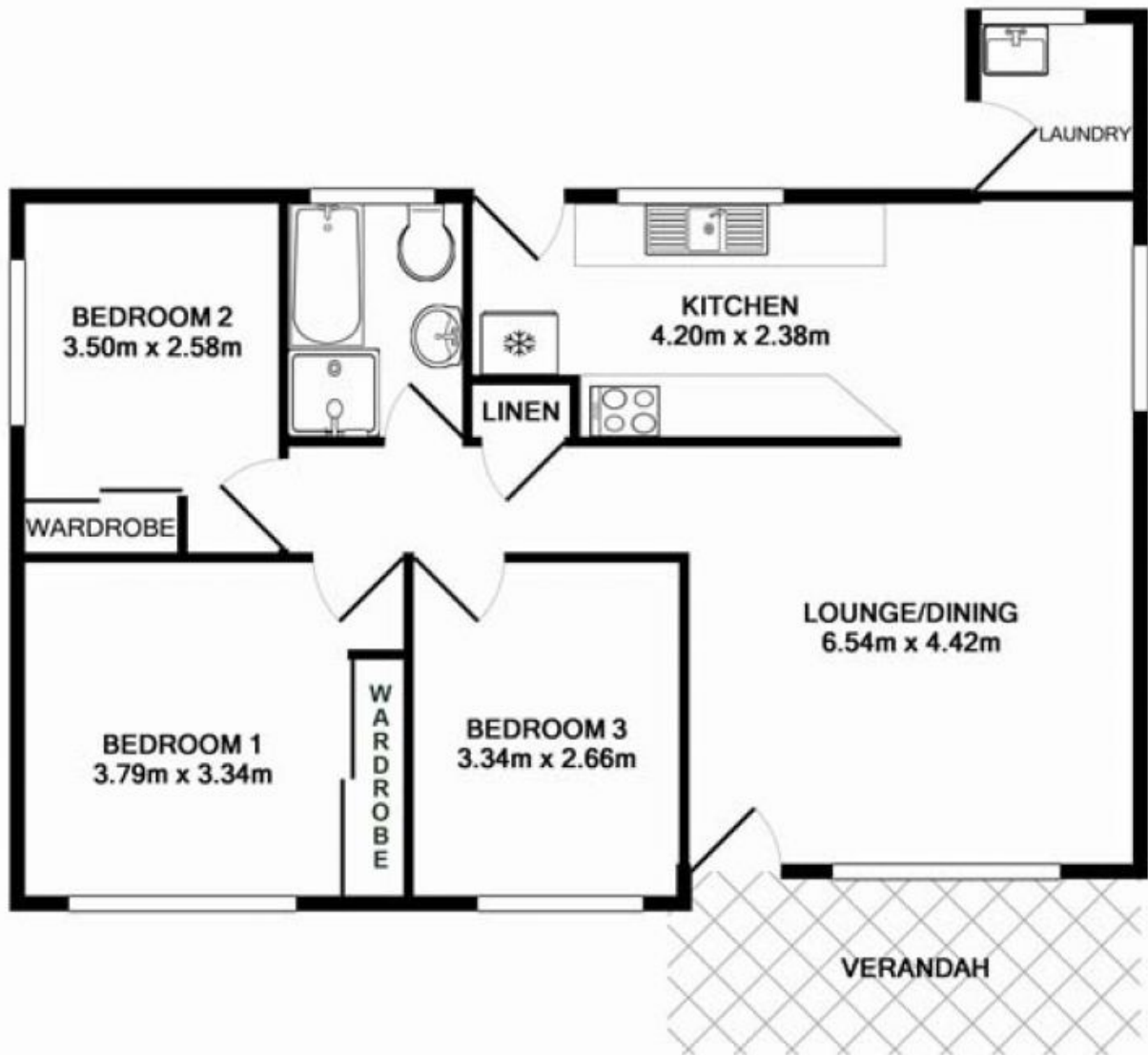

Measurements are approximate. Not to Scale. For illustrative purposes only.