

STONE

839sqm



17 Caley Road Bradbury, NSW



SOLD BY ANTHONY BEKIARIS - \$515,500

Price:

\$470,000 - \$510,000

Huge 839sqm Parcel Of Land

Situated in an idyllic tree lined location, this light filled home presents a rare opportunity to acquire a large parcel of land. A meticulous renovation has transformed this freestanding home and created an exquisite residence of chic contemporary style and great quality. With transport only moments away and being in close proximity to local schools and amenities makes this home a wonderful opportunity for the astute investor or first home buyer.

- * 4 bedrooms with built in wardrobes to three
- * Huge 839sqm flat & level block of land
- * Single carport with drive through access to the rear yard
- * Spacious lounge and dining rooms with polished timber flooring and revers cycle air conditioning
- * Modern kitchen with ample cupboard and bench space

Stone Real Estate -

Head Office

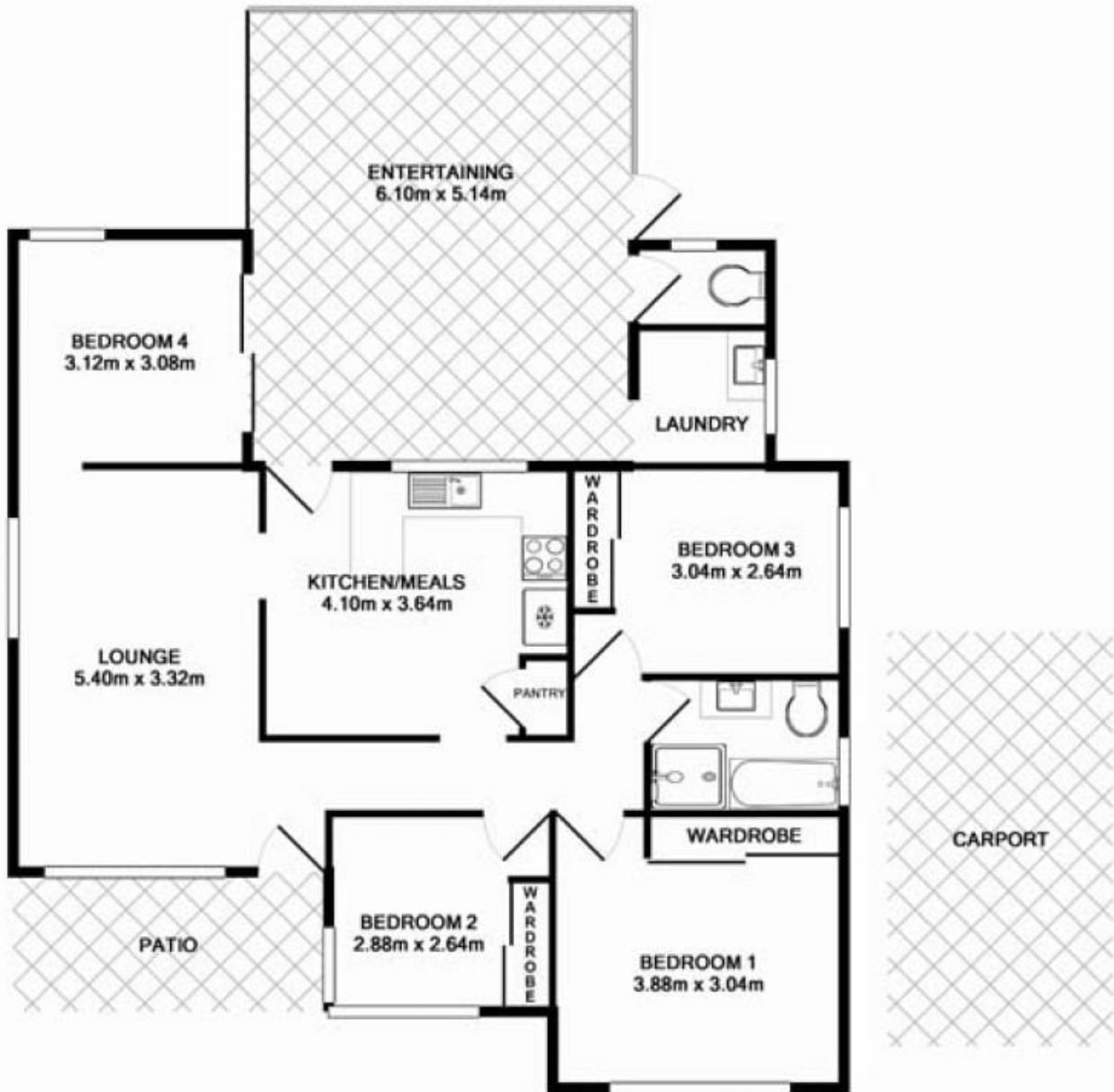

Measurements are approximate. Not to scale. Illustrative purposes only