

STONE

UNITS
35-43

Unit 37



37/5-7 Hoddle Avenue Bradbury, NSW

2 

1 

1 

Unique Opportunity - Ideal For New Touches

A private haven of surprising light and space positioned in a location with only a short walk to Bradbury Oval, Hoddle Avenue Shops, The Gordon Fetterplace Aquatic Centre and Campbelltown CBD. This fantastic opportunity features a big scope for the future to add further value. Ideal for first home buyers or the investor.

Price:

\$260,000 - \$280,000

Stone Real Estate -

Head Office

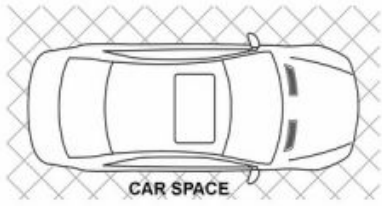
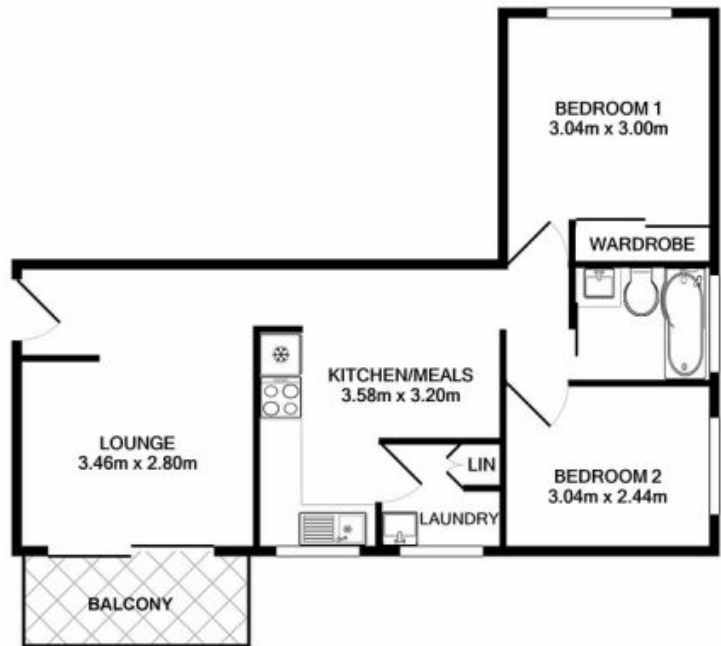

Measurements are approximate. Not to scale. Illustrative purposes only