



7 Tweed Place Ruse, NSW

3

1

4

**SOLD BY RUSSELL WYER & MICHELLE BALABKA - \$752,000**

**Price:** \$680,000 - \$720,000

- \* Lovely three bedroom home with loads of potential
- \* Large lounge room with slow combustion fire and split system air conditioning
- \* This home is waiting for you to add your personal touches
- \* Updated kitchen with electric cooking appliances, lots of bench space and a breakfast bar
- \* Single garage is currently utilised as a teenage retreat and workshop but could easily be converted back to a tandem garage
- \* Second toilet is located in the laundry
- \* Detached double colourbond garage will delight the tradesperson or hobbyist
- \* Large 839m2 block with generous side access to the side and rear yard
- \* Cul-de-sac location and within the school zone of Ruse Public school and Leumeah High School
- \* Virtual furniture is used in our photos



**Russell Wyer**

0414 867 707

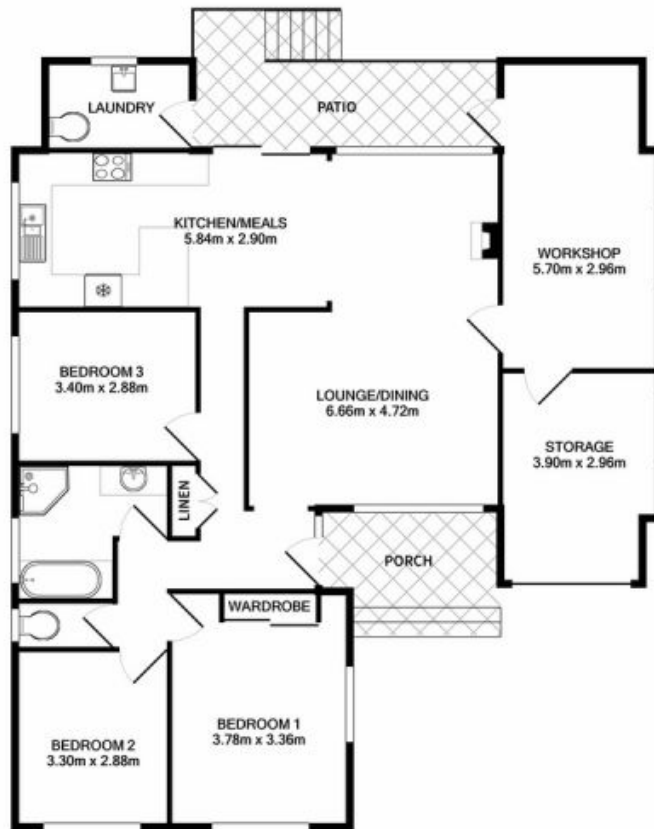
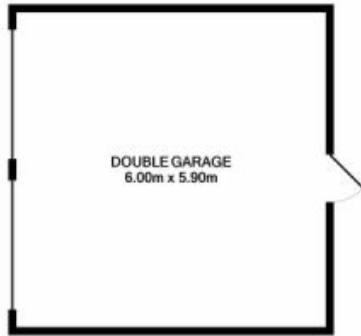

Measurements are approximate. Not to scale. Illustrative purposes only