



6 St Mark Close Blair Athol, NSW

5

2

6

Masterton Magic Family Home

- Originally built by Masterton Homes, spacious family friendly design, on low maintenance 550sqm block
- Features 4-5 bedrooms, walk-in robe / built-in robes, ensuite
- 3 living areas, ducted vacuum system
- Ducted air conditioning and ceiling fans
- Modern kitchen with granite bench tops and glass splashback, dishwasher
- Natural gas cooking, BBQ and hot water system
- Security system plus shutters
- Double garage with auto garage door plus secure side access for extra vehicles / boat / van etc.

Price: \$950,000 - \$990,000



Matthew Laverty

0418 281 032

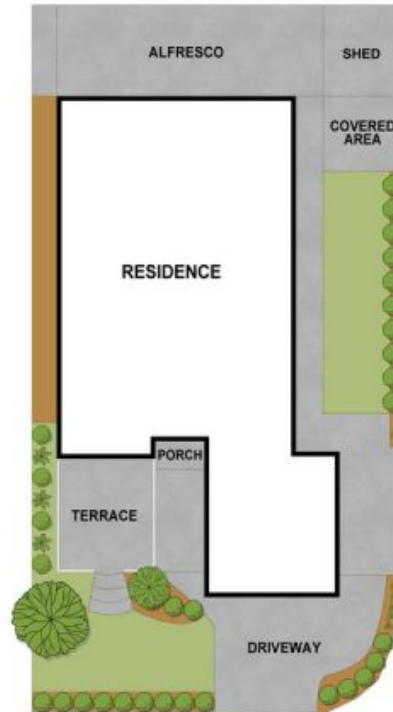

6 ST MARK CLOSE, BLAIR ATHOL

DISCLAIMER

PLANS SHOWN ARE FOR MARKETING PURPOSES ONLY. ALL DIMENSIONS ARE APPROXIMATE AND NOT TO SCALE. THEY ARE SUBJECT TO ERRORS AND INACCURACIES AND NO LIABILITY WILL BE ACCEPTED. INTERESTED PARTIES SHOULD MAKE THEIR OWN ENQUIRIES.
PRODUCED BY OPEN2VIEW 0467 999920.