



13/47 Stowe Avenue Campbelltown, NSW



### Location, Location, Location!!!

- \* Lovely open plan second floor apartment
- \* Large 20m2 enclosed terrace
- \* South Easterly position with bush reserve outlook
- \* Combined living, kitchen and dining area with floor to ceiling glazing
- \* Both bedrooms open onto the outdoor terrace
- \* Freshly painted in a modern colour palette and with new plush carpets throughout
- \* The kitchen boasts 'BOSCH' appliances including dishwasher and Caesarstone bench tops
- \* This apartment will suit owner occupiers or downsizing from a larger home
- \* Security parking with caged storage and lift access is provided
- \* Opposite Western Sydney University and located just 500m from Macarthur Square's cinema, restaurant precinct as well as Campbelltown Golf Course Fairways, this is arguably one of the best locations in Macarthur
- \* Very unique in size, Be the first to inspect this highly desirable apartment!!

Price:

\$555,000



**Gary Luke**

0418 451 105

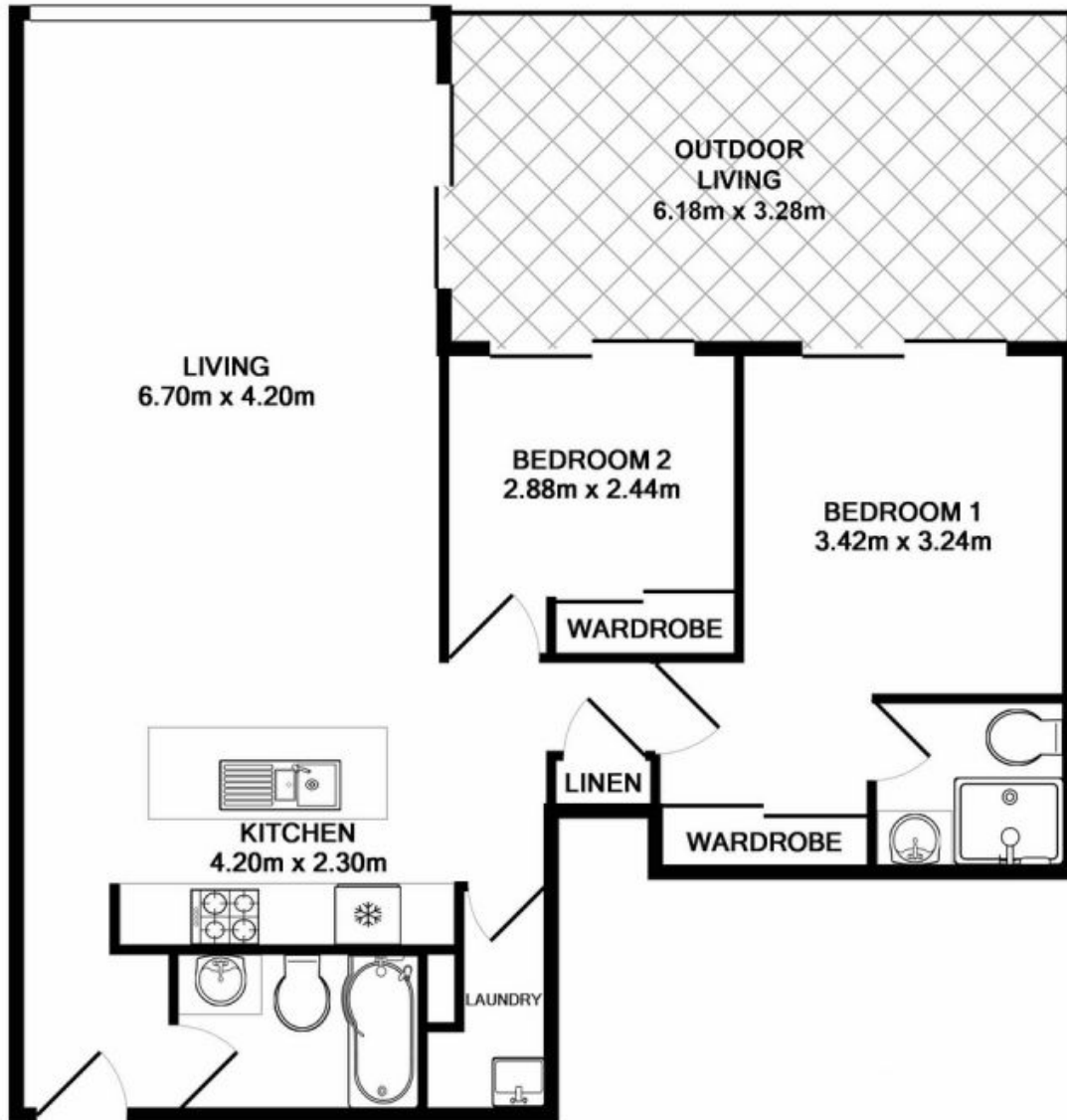

Measurements are approximate. Not to scale. Illustrative purposes only