



407/39-47 George Street Rockdale, NSW

2

2

1

Big, bright and modern

Set high up in a solid complex, this fresh young apartment is oriented towards a north-facing balcony, Investors and home owners will appreciate its contemporary finishes and open-plan layout, flowing out to two large balconies. In a quiet eastern pocket of Rockdale, the home is under 2km from the beach, a stroll from trains, shops and schools.

Price:

Contact Agent



George Kambouroglou

0422 421 111

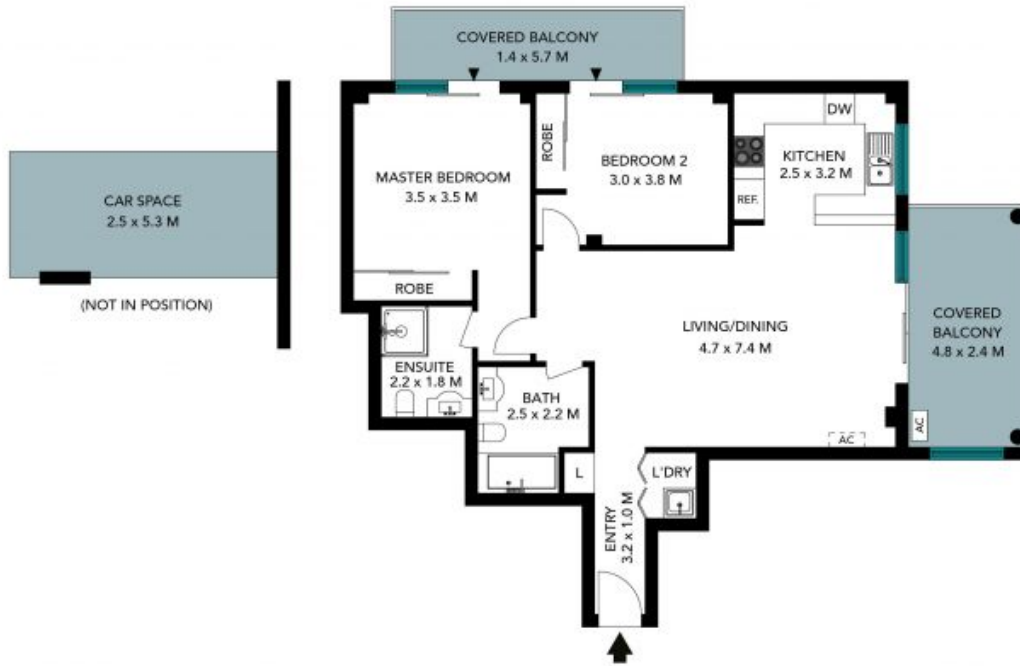

The floor plan is not to scale; measurements are indicative and in metres. Exterior elements are not in position. Plans should not be relied on. Interested parties should make and rely on their own enquiries. All other information provided has been collected from reliable sources but cannot be guaranteed for accuracy.



407/39 George Street, Rockdale



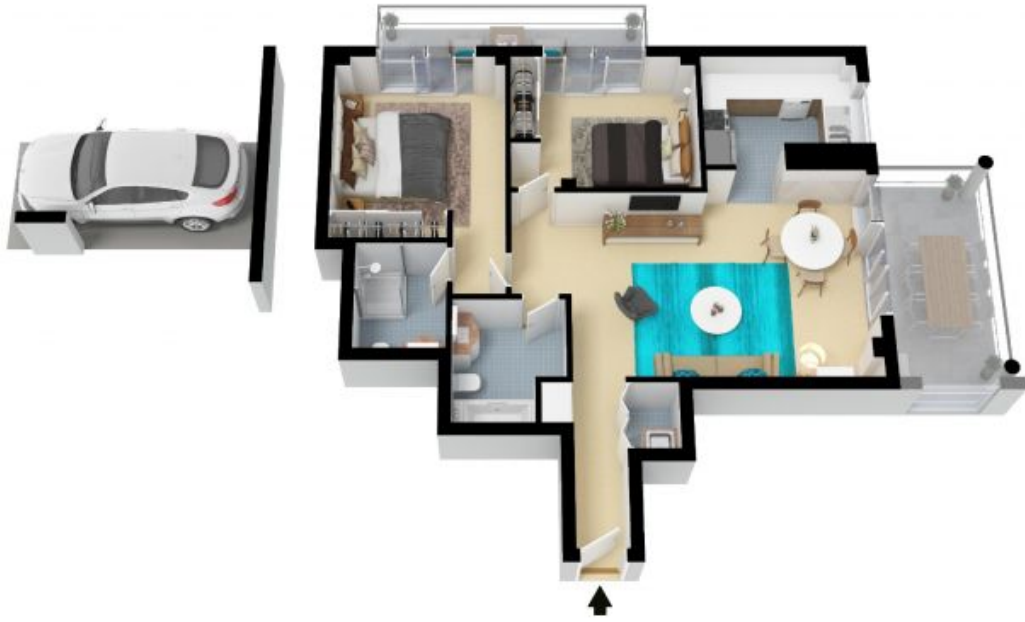

The floor plan is not to scale, measurements are indicative and in metres. All features included in this 3D plan are for inspiration purposes only. This is not an exact replica of the property or the position of exterior elements. Plans should not be relied on. Interested parties should make and rely on their own enquiries.

407/39 George Street, Rockdale

N ↗

STONE