

43/15-17 Wyoming Avenue Oatlands, NSW

1 1

### Low maintenance retirement villa in a friendly community

Peacefully set within Oatlands Gardens Retirement Village, this pristine ground floor villa enjoys the benefits of resort style living in a friendly over 55's community. It's in a quality neighborhood close to public transport, all good amenities, quiet and private with exceptional convenience.

**Price:** Deposit taken  
**Bond:** \$1,400  
**Available Date:** 27/05/2023



**Paul Alam**  
0422 004 969



**Olivia Makhlof**  
02 9557 9040

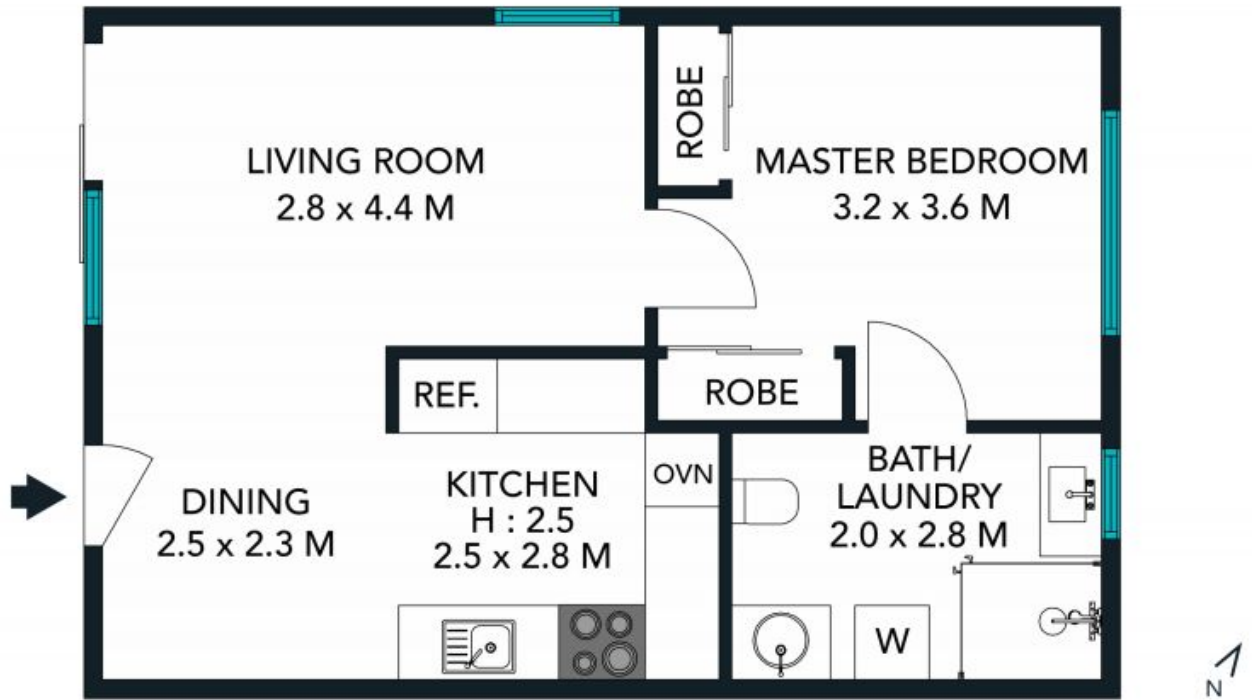

The floor plan is not to scale; measurements are indicative and in metres. Exterior elements are not in position. Plans should not be relied on. Interested parties should make and rely on their own enquiries.

43/15-17 Wyoming Avenue, Oatlands  
stonerealestate.com.au

Produced by DIAKRIT



The floor plan is not to scale; measurements are indicative and in metres. All features included in this 3D plan are for inspiration purposes only. This is not an exact replica of the property or the position of exterior elements. Plans should not be relied on. Interested parties should make and rely on their own enquiries.

43/15-17 Wyoming Avenue, Oatlands  
stonerealestate.com.au

Produced by DIAKRIT