

9/47 Doomben Avenue Eastwood, NSW



Attention First Home Buyers: Eastwood public school, north-facing & double brick.

Quietly positioned on the third floor, this spacious and welcoming unit enjoys an abundance of natural light throughout. Offering a north-facing aspect and a practical floorplan, this well presented unit offers a secure lifestyle opportunity. Centrally located, this convenient unit is footsteps away from trains, buses, restaurants and all Eastwood offers. With a lifestyle suitable for young couples, first-home buyers or the savvy investor, it is the perfect opportunity to make this unit your home.

Price: Auction
Council Rates: \$317.00 p/q
Water Rates: \$164.00 p/q
Strata Rates: \$749.00 p/q



Brian Kong

0435 333 383

9/47 Doomben Avenue
Eastwood

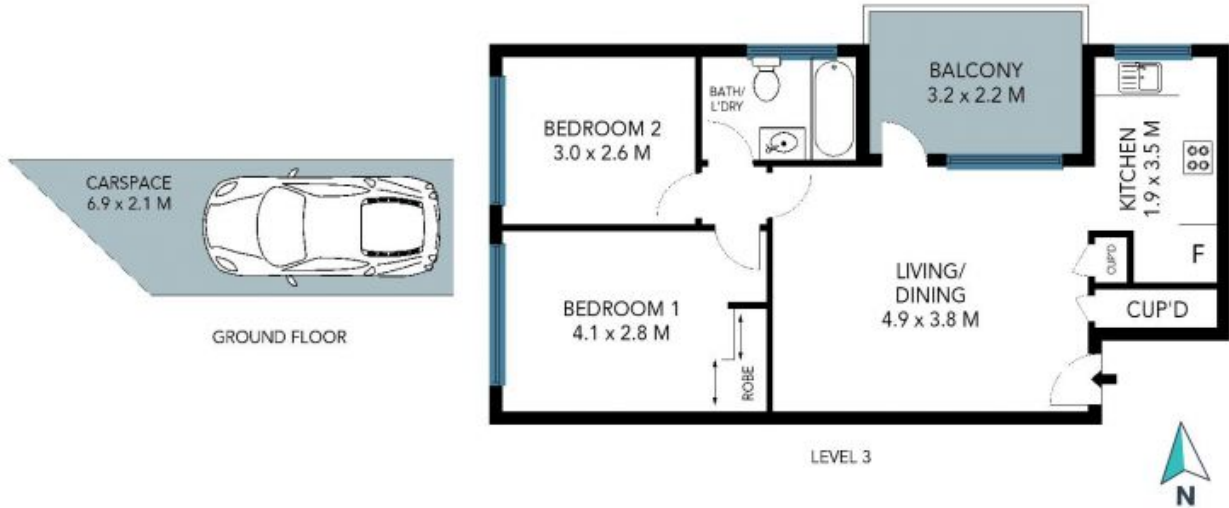

The site plan and floor plan are not to scale; measurements are indicative and in metres. Bushes and trees are placed for illustration purposes. Plans should not be relied on. Interested parties should make and rely on their own enquiries. All other information provided has been collected from reliable sources but cannot be guaranteed for accuracy.