

27 Pemberton Boulevard Lisarow, NSW

4 

2 

2 

Single level living in a prime location

Nestled in the charming suburb of Lisarow, this beautifully designed single-level family home offers the perfect blend of comfort, style, and convenience. With its spacious layout and prime location, this property is truly a dream come true.

Price: \$985,000



Brian Milson

0411 381 220

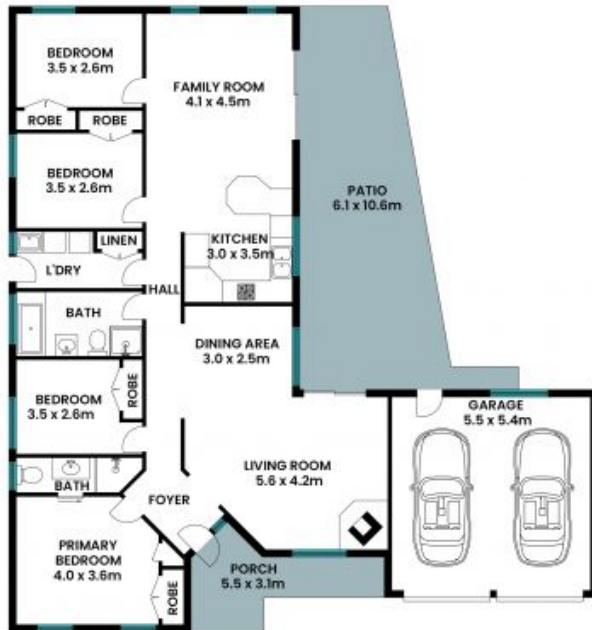

First Floor

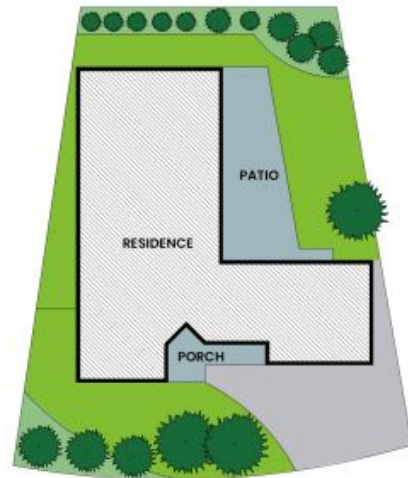

Site Plan

Internal Area: 134sqm
External Area: 77sqm

PLEASE NOTE: These Floor Plan + Site Plans have been generated for marketing purposes and are to be used as a guide only. While all care is taken, no guarantee can be given in respect of accuracy, sizes and dimensions are approximate, actual may vary.