

18/8 Victoria Parade Manly, NSW 2  1 

Art Deco gem seconds between Manly Beach and Sydney Harbour

'Rotorua' is positioned in one of the most tightly held locations in Manly. With the beach and harbour at either end of the street whilst on the cusp of Manly village, this location is simply unbeatable. Recently renovated, this cosy apartment, peacefully located at the rear of the block blends vintage charm with modern enhancements in an art deco block.

Price: Deposit Taken
Bond: \$3,400
Available Date: 27/07/2023



Tameka Kitchener



Briannah Ferris

02 8962 2200

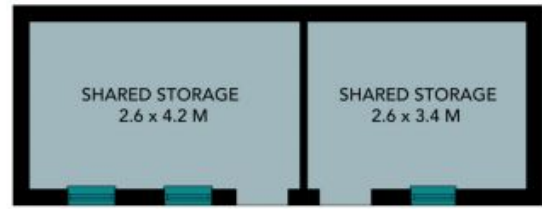

(NOT IN POSITION)



SITE PLAN



The floor plan is not to scale, measurements are indicative and in metres. Exterior elements are not in position. Plans should not be relied on. Interested parties should make and rely on their own enquiries. All other information provided has been collected from reliable sources but cannot be guaranteed for accuracy.

18/8 Victoria Parade
Manly

STONE

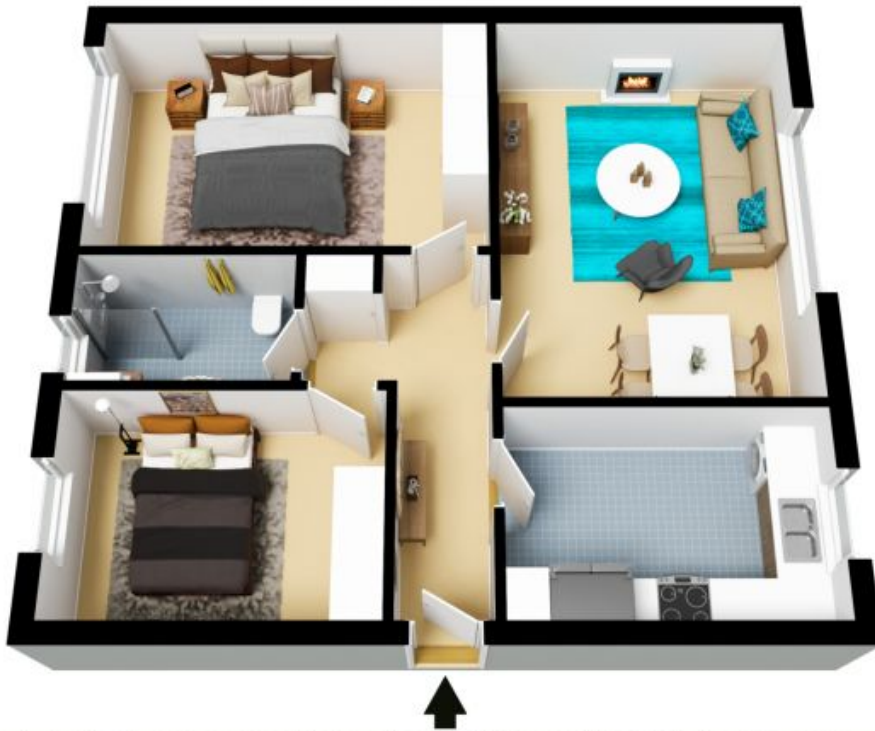

The floor plan is not to scale; measurements are indicative and in metres. All features included in this 3D plan are for inspiration purposes only. This is not an exact replica of the property or the position of exterior elements. Plans should not be relied on. Interested parties should make and rely on their own enquiries.