

10 Belmont Avenue Spring Farm, NSW



The Perfect Family Retreat

Welcome to your personal sanctuary, where luxury meets comfort in our stunning three-bedroom double-storey home, complete with a private luxury spa. Prepare to immerse yourself in a world of relaxation and elegance, where every day feels like a blissful retreat.

Price: \$840,000
Strata Rates: \$336.00 p/q



Adam Shmeissem

0450 765 945



Adam Shmeissem

0450 765 945



First Floor

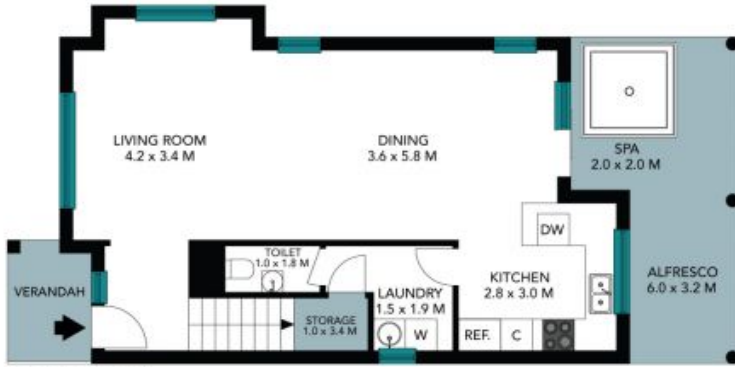

Ground Floor



(NOT IN POSITION)



The floor plan is not to scale, measurements are indicative and in metres. Labels elements are not in position. Plans should not be relied on. Interested parties should make and rely on their own enquiries. All other information provided has been collected from reliable sources but cannot be guaranteed for accuracy.

10 Belmont Avenue
Spring Farm



First Floor



Ground Floor



The floor plan is not to scale; measurements are indicative and in metres. All features included in this 3D plan are for inspiration purposes only. This is not an exact replica of the property or the position of exterior elements. Plans should not be relied on. Interested parties should make and rely on their own enquiries.