



33/578-584 Pacific Highway Killara, NSW

3  1  1 

### Tranquil Three Bedroom - Oversized - Lush Green Views

Set back from the road in a leafy complex this apartment offers a harmonious blend of modern comfort and convenience. Sunny north facing with spacious interiors and flooded with natural light the inviting living areas and oversized balcony is the ideal place to relax and call home.

**Price:** Deposit Taken  
**Available Date:** 17/07/2023



**Chase Kuo**  
0466 363 140



**Stephanie Ryan**  
0451 307 760

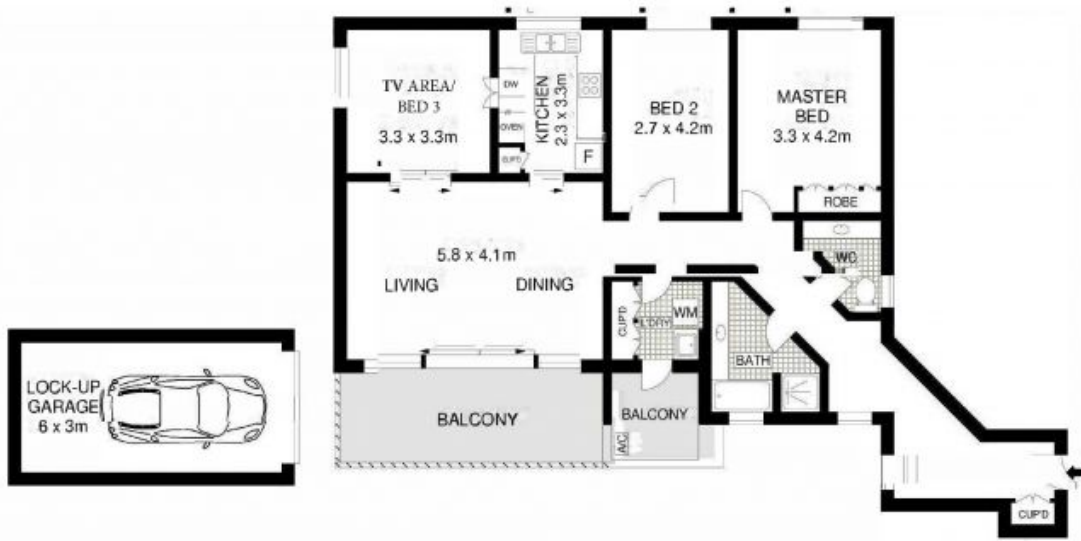

Total area: 106sqm approx.

The site plan and floor plan are not to scale; measurements are indicative and in metres. Bushes and trees are placed for illustration purposes. Plans should not be relied on. Interested parties should make and rely on their own enquiries. All other information provided has been collected from reliable sources but cannot be guaranteed for accuracy.