



8 Farmer Avenue Wyee, NSW 4 2 2

**Available for inspection 7 days a week!**

Nestled within the prestigious Radcliffe Estate, this stunning single-level residence is full of charm and sophistication. Boasting four bedrooms, two bathrooms, and a spacious double garage, this property offers a unique blend of modern comfort and quirky character that will steal your heart. With open plan living and dining space, separate media room, fully landscaped gardens with water tanks, solar panels, ducted air conditioning, wood burner fireplace and a Hamptons facade that boasts side access for trailers, boats or caravans?. the owners have left nothing to spare in allowing its new owner the opportunity to move In and enjoy!

**Price:** Contact Agent



**Volkan Akintetik**

0499 830 247



**Reece Caira**

0431 013 342

8 Farmers Avenue  
Wyee

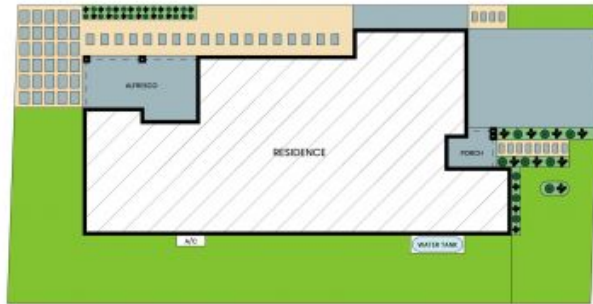

Site Plan



Internal Area: 210 sqm  
External Area: 26 sqm  
Total Area: 236 sqm

PLEASE NOTE: These Floor Plan + Site Plans have been generated for marketing purposes and are to be used as a guide only. While all care is taken, no guarantee can be given in respect of accuracy, sizes and dimensions are approximate, actual may vary