



102/16-18 Wassell Street Matraville, NSW



Under Contract

Private community with Pool and Gym facilities. This well-kept townhouse boasts 2 levels of spacious living areas. Newly painted and carpeted throughout. Great for a growing family and would make a good investment.

Features we love:

- 3 bedrooms with built-ins, master suite with balcony
- 2 bathrooms plus powder room,
- Main bathroom includes bathtub
- Lock-up garage with internal access,
- Rear pedestrian access
- Short walk to St Spyridon College and Matraville Sports High School
- 6 mins drive to Heffron Centre
- 8 mins drive to East Garden Westfield's

Price: UNDER CONTRACT

Council Rates: \$404.00 p/q

Water Rates: \$214.00 p/q

Strata Rates: \$891.00 p/q

Stone Real Estate -

Head Office

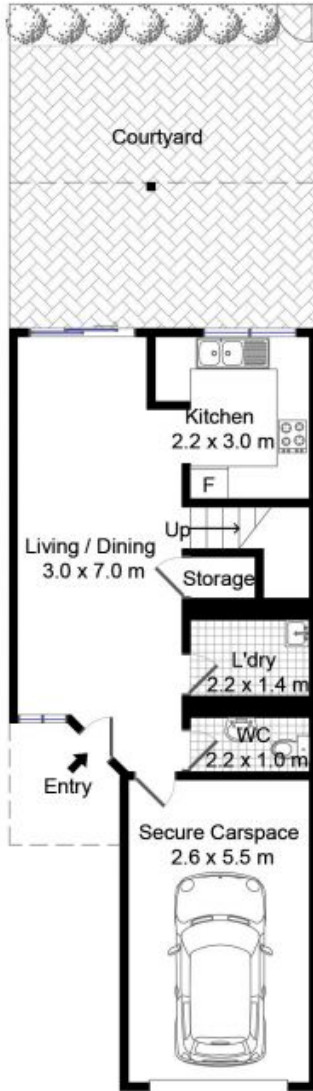

Entry Level

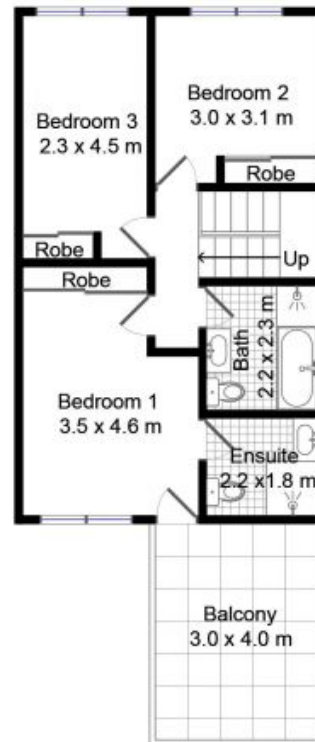

Level One

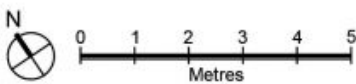

Disclaimer: Plans are indicative only and should be checked by the prospective purchaser. The information herein is gathered from sources we believe to be reliable.

Unit 102, 16-18 Wassell Street, Matraville