

602/32 Mort Street Braddon, ACT



## Modern and high quality living in an ideal location!

The Yamaroshi complex is inspired by Japanese living, these apartments offer sleek and innovative design with masses of inbuilt storage and integrated appliances. Located in the bustling Braddon restaurant precinct you will be spoilt for choice when it comes to your morning coffee or evening meal. With Lonsdale street and the CBD at your doorstep, leave your car at home and enjoy the freedom of walking to where you need to be.

These apartments offer it all, sleek modern style and city convenience.

### Features Overview:

- Single-level floorplan apartment on the top level.
- Double-glazed
- NBN connected with FTTP
- Age: 4 years (built in 2019)
- Units plan number: 4800
- EER (Energy Efficiency Rating): 6 Stars

Price:

\$699,000+



**Jess Smith**

0410 125 475



**Alex Ogbonna**

0423 535 024

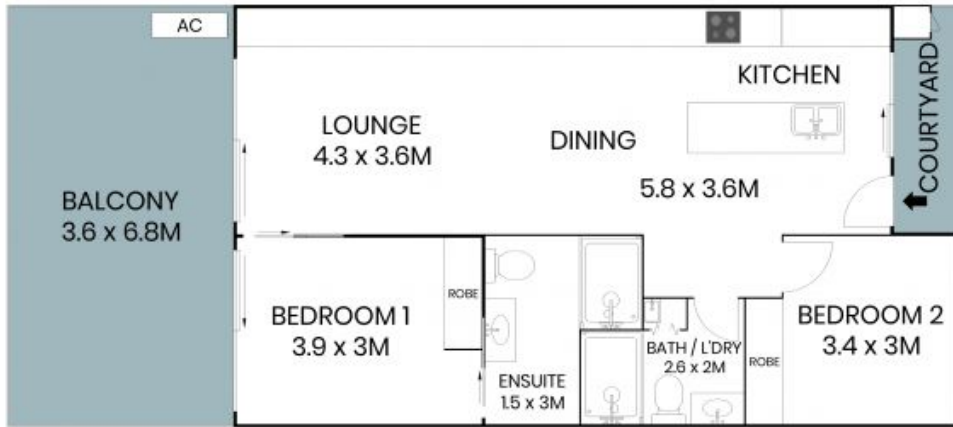

The site plan and floor plan are not to scale; measurements are indicative and in metres. Bushes and trees are placed for illustration purposes. Plans should not be relied on. Interested parties should make and rely on their own enquiries. All other information provided has been collected from reliable sources but cannot be guaranteed for accuracy.

602/32 Mort Street  
Braddon

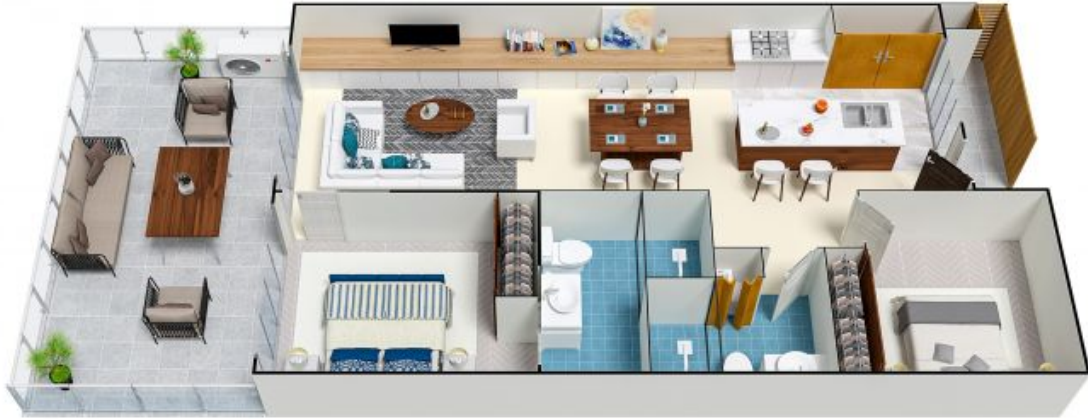

The floor plan is not to scale; measurements are indicative and in metres. All features included in this 3D plan are for inspiration purposes only. This is not an exact replica of the property or the position of exterior elements. Plans should not be relied on. Interested parties should make and rely on their own enquiries.