

STONE



8 Mayne Street North Rothbury, NSW

4 

2 

6 

Your Four Bedroom Home with Teen Retreat

Nestled on a massive 1616sqm approx block, this four bedroom home offers beautifully breathtaking proportions and plenty of modern living for the whole family. Bursting with personality this exceptional home boasts a newly finished bathroom and deluxe modern kitchen ? with a quality rustic twist. Boasting high ceilings throughout with an entire wing dedicated to the parents retreat, this home will accommodate the whole tribe with an additional teen studio, extensive shedding/garages and gorgeous family entertaining. Just 2kms to the bustling Huntlee shopping precinct/ day care and only 3kms to Branxton Primary School.

Price: \$960,000
Council Rates: \$596.00 p/q



Debra Ford

0413 478 655



Samantha Shone

0423 682 959

8 Mayne Street
North Rothbury

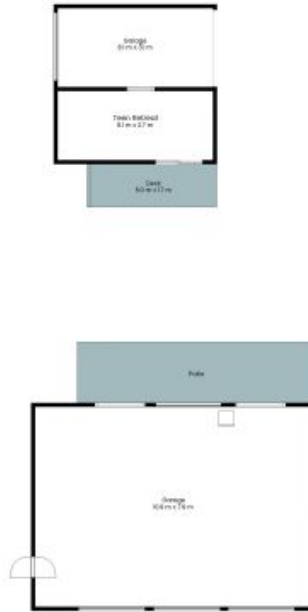

Site Map



The site plan and floor plan are not to scale; measurements are indicative and in metres. Bushes and trees are placed for illustration purposes. Plans should not be relied on, interested parties should make and rely on their own enquiries. All other information provided has been collected from reliable sources but cannot be guaranteed for accuracy.

