



30/2-10 Coolgardie Street Elanora, QLD

3

2

1

Exquisite lakefront oasis at secluded cove resort

Tropical island vibes paired with exotic inclusions bring a touch of paradise to this sublimely renovated lakeside townhouse at the 'Isle of Palms.' Detailed to perfection, the stunning interiors effortlessly connect with the outdoors and serene beauty of the surrounds. The secure gated community is a stroll to The Pines Elanora and Currumbin Creek, with golden beaches nearby.

- Living/dining area bathed in ambient light features polished concrete floors
- Treasured artefacts, natural elements and handcrafted appointments throughout
- Flows to gorgeous north facing entertainers' terrace with tranquil water views
- Designer kitchen provides induction cooking, select fittings, stone benchtops
- Dreamy bedrooms with seagrass matting, master opens onto waterfront balcony
- Luxe bathrooms, attic accessed via dropdown ladder, internal entry to garage
- Complex offers resort style pools, spas, tennis courts and barbecue facilities
- Ride bike to Currumbin Alley or seaside cafes and restaurants at Palm Beach

Disclaimer: All information (including but not limited to the property area, floor size, price, address and general property description) is provided as a convenience to you, and has been provided to Stone by third parties. Stone and Stone's partners have no belief one ...

Price:

Contact Agent



Brendan Andrews

0417 788 882



Rebecca Leo

0419 880 822

30/2-10 Coolgardie Street
Elanora

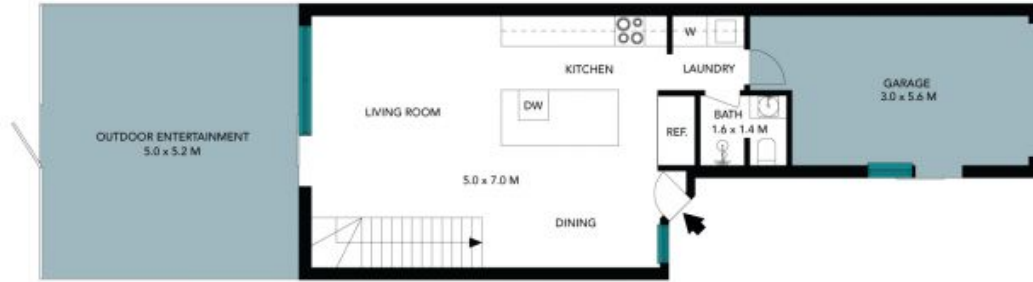
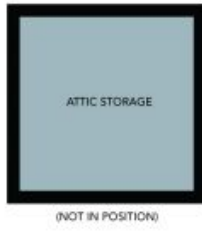

Internal Living: 102 sqm
External Living: 37 sqm
Total Living Area: 139 sqm



The floor plan is not to scale, measurements are indicative and in metres. Certain elements are not in position. Plans should not be relied on. Interested parties should make and rely on their own enquiries. All other information provided has been collected from reliable sources but cannot be guaranteed for accuracy.

30/2-10 Coolgardie Street
Elanora



1st Floor



Ground Floor

Internal Living: 102 sqm
External Living: 37 sqm
Total Living Area: 139 sqm



The floor plan is not to scale; measurements are indicative and in metres. All features included in this 3D plan are for inspiration purposes only. This is not an exact replica of the property or the position of exterior elements. Plans should not be relied on. Interested parties should make and rely on their own enquiries.