



103/60 Jefferson Lane Palm Beach, QLD



Welcome to 'The Jefferson' Palm Beach

Boasting a design by award-winning architects BDA, and situated on level one of seven floors, this beautiful apartment offers three great sized bedrooms, two bathrooms and two secure car spaces.

Price: \$1,320,000



Rebecca Leo

0419 880 822

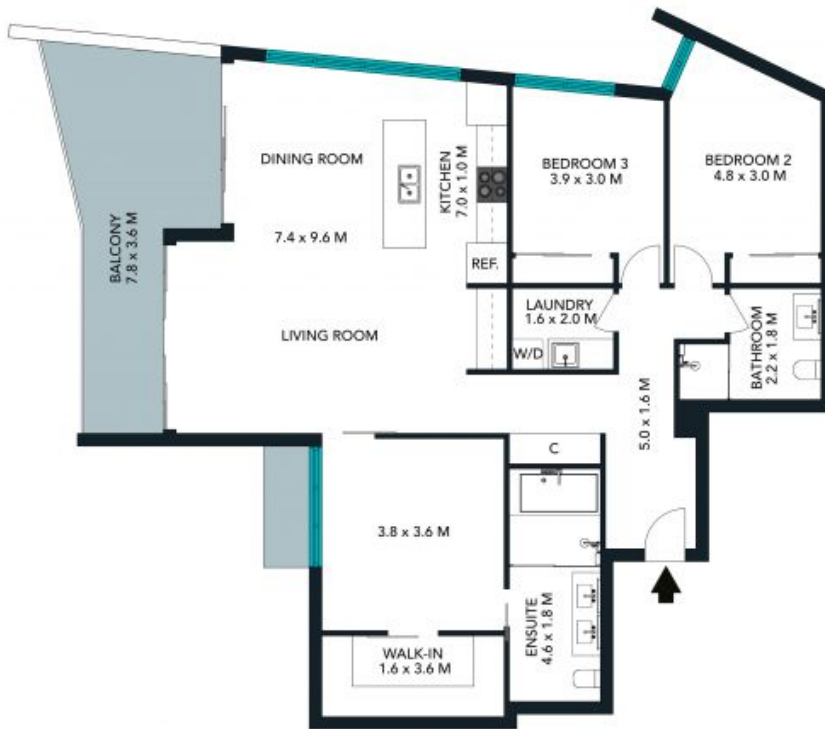

Internal Living: 118 sqm approx
 External Living: 20 sqm approx
 Total Living Area: 138 sqm approx

The floor plan is not to scale, measurements are indicative and in metres. Color or elements are not to position. Plans should not be relied on. Interested parties should make and rely on their own enquiries. All other information provided has been collected from reliable sources but cannot be guaranteed for accuracy.

103/60 Jefferson Lane, Palm Beach





Internal Living: 118 sqm approx
External Living: 20 sqm approx
Total Living Area: 138 sqm approx

The floor plan is not to scale, measurements are indicative and in metres. All features included in this 3D plan are for inspiration purposes only. This is not an exact replica of the property or the position of exterior elements. Plans should not be relied on. Interested parties should make and rely on their own enquiries.



103/60 Jefferson Lane, Palm Beach

