



57 Sky Royal Terrace Burleigh Heads, QLD

4

2

2

Stylish beach vibe oasis with picturesque backdrop

Enjoying sweeping district views, this stunning haven is custom designed to embrace its hillside position and perfect north facing aspect. The layout flows from the light filled living areas to sunlit alfresco entertaining retreats to offer you the ultimate coastal lifestyle. The generous 1,090sqm block is in a family-friendly pocket, near schools, shops and endless beaches.

Price: \$950,000



Rebecca Leo

0419 880 822



LOWER LEVEL 1

Internal Living: 165 sqm approx
External Living: 67 sqm approx
Total Living Area: 232 sqm approx



GROUND LEVEL

The floor plan is not to scale, measurements are indicative and in metres. All features included in this 3D plan are for inspiration purposes only. This is not an exact replica of the property or the position of exterior elements. Plans should not be relied on. Interested parties should make and rely on their own enquiries.

57 Sky Royal Terrace, Burleigh Heads



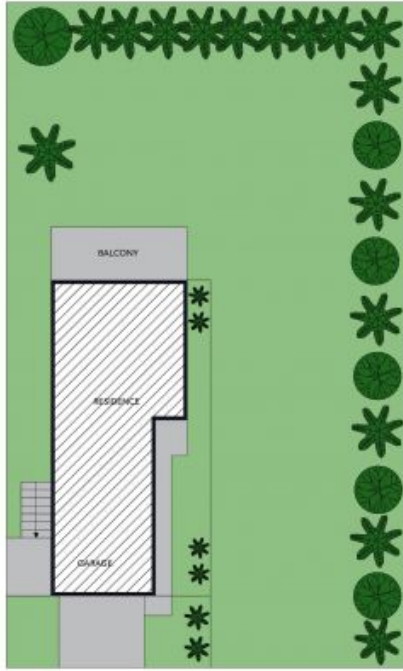

SITE PLAN



LOWER LEVEL 1



GROUND LEVEL

Internal Living: 165 sqm approx
 External Living: 67 sqm approx
 Total Living Area: 232 sqm approx

The site plan and floor plan are not to scale; measurements are indicative and in metres. Bushes and trees are placed for illustration purposes. Plans should not be relied on. Interested parties should make and rely on their own enquiries. All other information provided has been collected from reliable sources but cannot be guaranteed for accuracy.



57 Sky Royal Terrace, Burleigh Heads

