



76 Bosun Boulevard Banora Point, NSW

5

2

2

Prime waterfront position with absolute privacy

Enjoying a prime position, with uninterrupted and majestic views of the Tweed River, this generously sized double storey family home on a 1,038sqm parcel is an entertainer's delight and perfect for boating enthusiasts. Situated in the exclusive Oxley Cove enclave, the home is just 10 minutes to Coolangatta, Gold Coast airport and Tweed Coast restaurants, cafes and beaches.

Price: \$1,545,000

**Stone Real Estate -
Head Office**

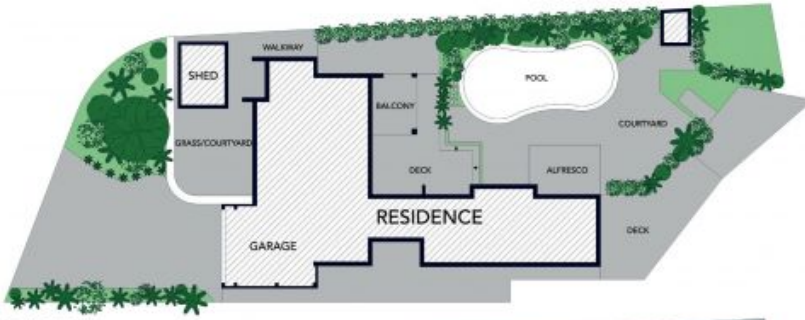

SITE PLAN



GROUND FLOOR



1ST FLOOR

Internal Living: 468 sqm approx
 External Living: 427 sqm approx
 Total Living Area: 895 sqm approx

The site plan and floor plan are not to scale, measurements are indicative and in metres. Shades and lines are placed for illustration purposes. Plans should not be relied on. Interested parties should make and rely on their own enquiries. All other information provided has been collected from reliable sources but cannot be guaranteed for accuracy.



76 Bosun Boulevard, Banora Point





Internal Living: 468 sqm approx
 External Living: 427 sqm approx
 Total Living Area: 895 sqm approx

The floor plan is not to scale, measurements are indicative and in metres. All features included in this 3D plan are for inspiration purposes only. This is not an exact replica of the property or the position of exterior elements. Plans should not be relied on. Interested parties should make and rely on their own enquiries.



76 Bosun Boulevard, Banora Point

