

15 Tasman Drive Gerringong, NSW



SOLD BY STONE REAL ESTATE | HELENA CRUMPTON & GREG CRUMPTON

Price: \$3,740,000

True essence of executive coastal living

With its breathtaking ocean views and architecturally designed by PRM Architects, this incredible property is without doubt one of Gerringong's most fabulous homes. Here the owners should be commended for their vision to create such a unique escape nestled amongst the tropical Balinese gardens, which wrap around the home to provide its own private world.

The modern kitchen and beautiful living and dining areas open via glass bi-fold doors direct to the magnesium lap pool and provide for easy living and impressive entertaining.

The incredible main bedroom is a true retreat in itself and must be seen to be believed. Escape to the sunken spa or relax in front of the fire while watching the waves roll in along Werri Beach. The ensuite shower is positioned to capture the breathtaking views. The balcony is perfect for your morning sunrise coffee or you can catch up on your emails at the...



Helena Crumpton

0415 119 019



Greg Crumpton

0418 557 185

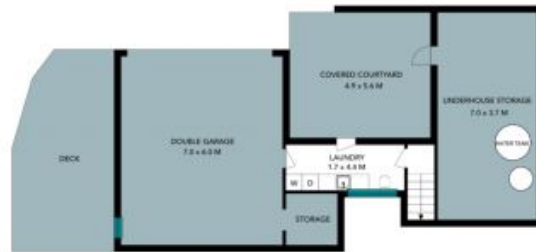

The floor plan is not to scale, measurements are indicative and in metres. Exterior elements are not in position. Plans should not be relied on, interested parties should make and rely on their own enquiries. All other information provided has been collected from reliable sources but cannot be guaranteed for accuracy.

15 Tasman Drive
Gerringong



LOWER GROUND FLOOR



GROUND FLOOR



1ST FLOOR



The floor plan is not to scale; measurements are indicative and in metres. All features included in this 3D plan are for inspiration purposes only. This is not an exact replica of the property or the position of exterior elements. Plans should not be relied on. Interested parties should make and rely on their own enquiries.