

74B North West Arm Road Gymea, NSW



Tranquil family haven ensures peaceful lifestyle

Tucked away and blessed with leafy outlooks from a bushland setting, this captivating family residence delivers an oasis of tranquility. It reveals vast interiors set below high raked ceilings, multiple balconies plus a backyard amidst natural greenery. Its location has easy access to local shops, coffee spots, schools, buses and the station, while handy to South Village and Miranda Westfield.

- Expansive two storey layout showcases open plan living, dining and kitchen zone
- Superbly presented interior with exposed beamed ceilings and timber floorboards
- Designed to enjoy smooth indoor/outdoor flow onto spacious entertaining balcony
- Gourmet kitchen is appointed with Miele appliances and stone crafted benchtops
- Four comfortable bedrooms, built/walk-in robes, one features loft/kids retreat
- Main bedroom suite offers parents' retreat with double height void and windows
- Two designer bathrooms, family bathroom has elegant bathtub and walk-in shower
- Tandem parking spaces, air conditioning, gas heating bayonets and ceiling fans

Price: Contact Agent
Council Rates: \$361.70 p/q
Water Rates: \$173.29 p/q



Will Soulos

0403 065 608

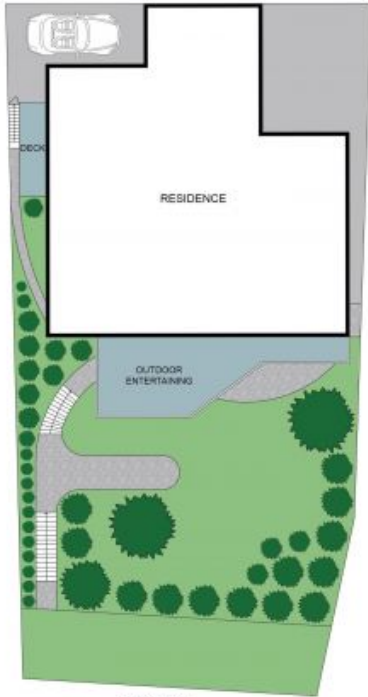

Site Plan



Upper Ground



Loft

Lower Ground



The site plan and floor plan are not to scale; measurements are indicative and in metres. Bushes and trees are placed for illustration purposes. Plans should not be relied on. Interested parties should make and rely on their own enquiries. All other information provided has been collected from reliable sources but cannot be guaranteed for accuracy.

74B North West Arm Road,
Gymea

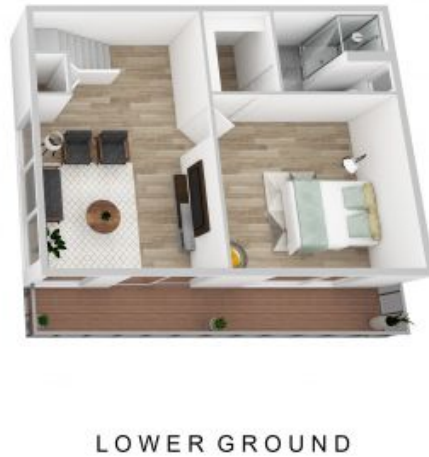

The site plan and floor plan are not to scale; measurements are indicative and in metres. Bushes and trees are placed for illustration purposes. Plans should not be relied on. Interested parties should make and rely on their own enquiries. All other information provided has been collected from reliable sources but cannot be guaranteed for accuracy.