

2 South Tacoma Road Tacoma South, NSW

5

2

1

Unique opportunity with its architectural design

Welcome to your dream dwelling, nestled in the highly coveted and tranquil enclave of Tacoma South. This remarkable residence rests upon an expansive dual waterfront reserve, spanning a generous 1874 sqm, and boasts a distinctive architectural design that sets it apart.

Price:

Contact Agent



Abdullah Choudhari

0401 977 187



Jameel Hasan

0468 645 844

2 South Tacoma Road
Tacoma South

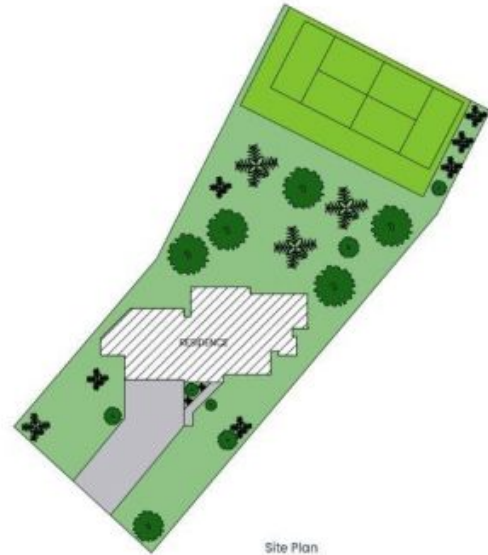

Internal Area: 220 sqm
 External Area: 284 sqm
 Garage Area: 20 sqm
 Storage: 9sqm
 Total Area: 533 sqm

PLEASE NOTE: These Floor and Site Plans have been generated for marketing purposes and are to be used as a guide only. While all care is taken, no guarantee can be given in respect of accuracy, sizes and dimensions are approximate, actual may vary.